

IRIDIUM

PAROIS DE DOUCHE

FRONTAL:

2 FIXES + 1 COULISSANT

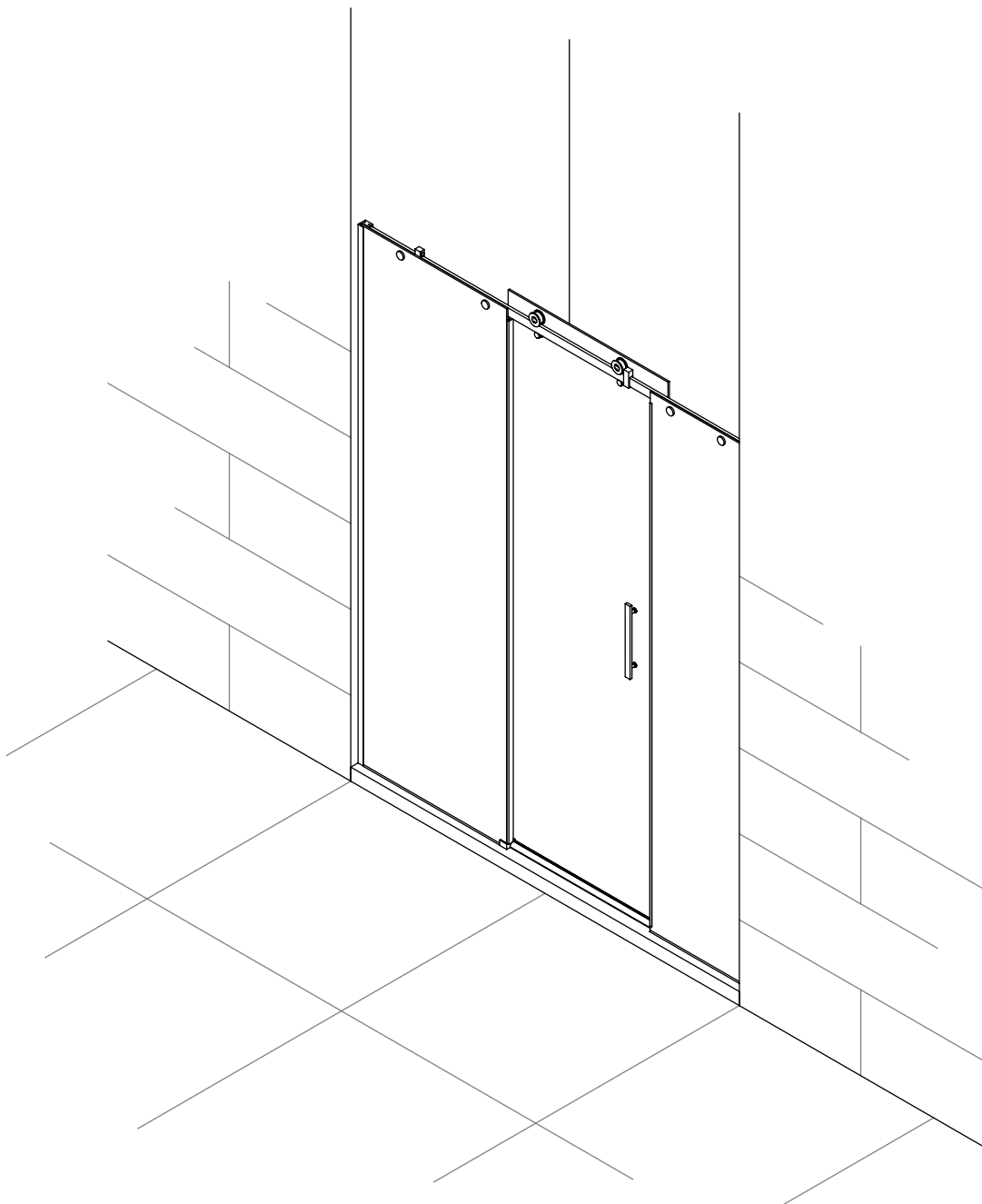

LERAC DIFFUSION

1

Présenter le profilé mural et tracer les perçages
*(idem de l'autre côté)

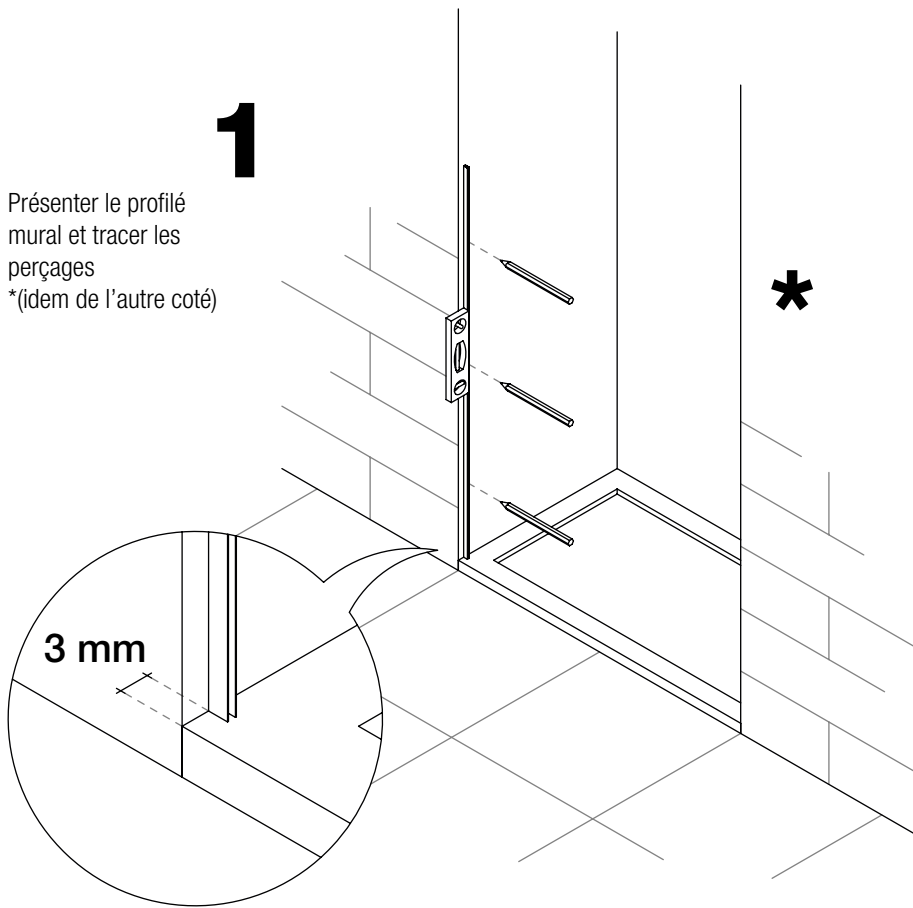

3 mm

*

2

Percer avec foret de 6mm
*(idem de l'autre côté)

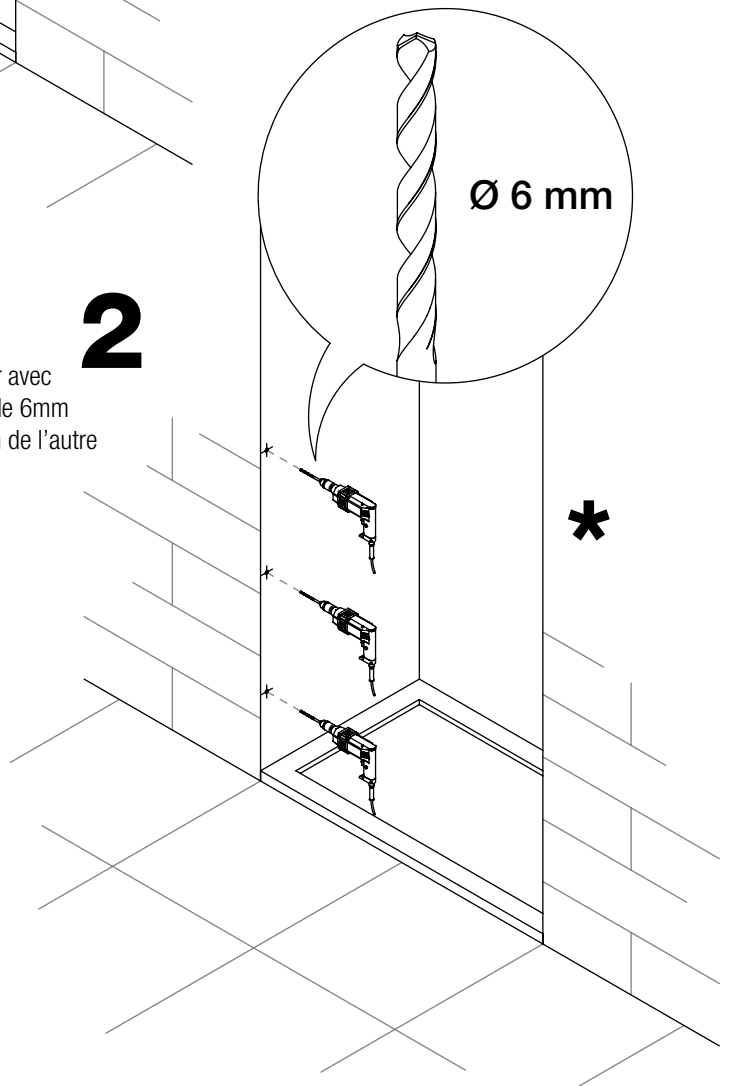

Ø 6 mm

*

3

Viser le profilé au mur avec chevilles de 5 et vis de 3x30 de chaque côté.
*(idem de l'autre côté)

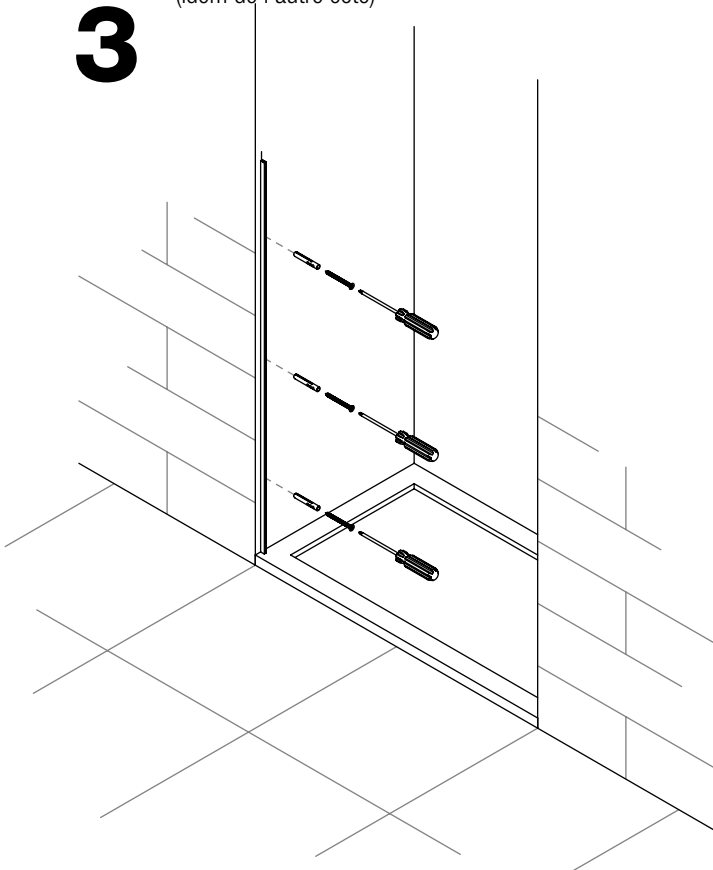

4

Positionner les bandes adhésives sur le receveur et introduire les 2 verres fixes dans les profilés en reposant sur les bandes.

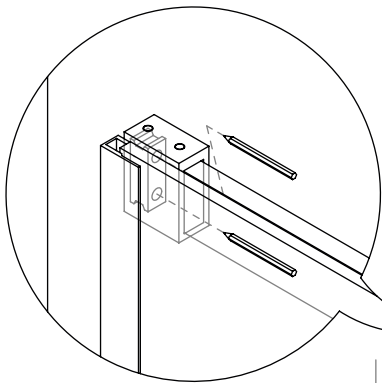
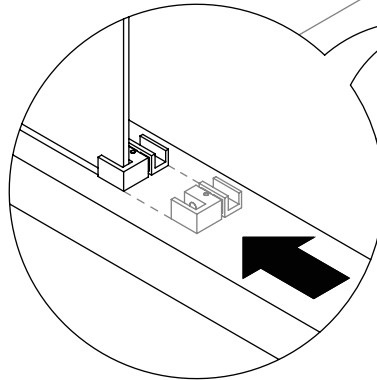
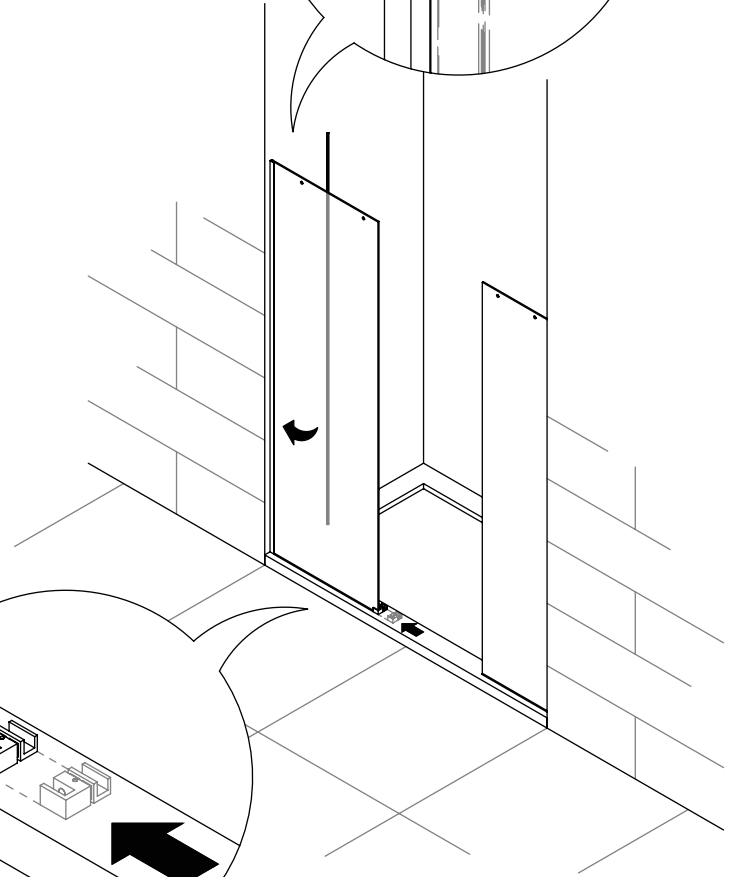
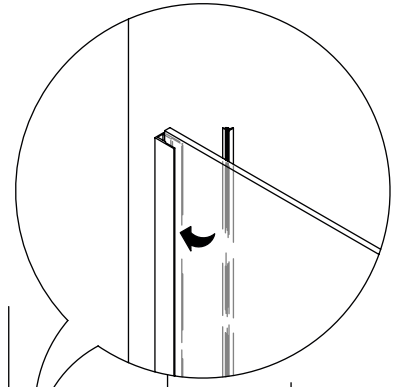
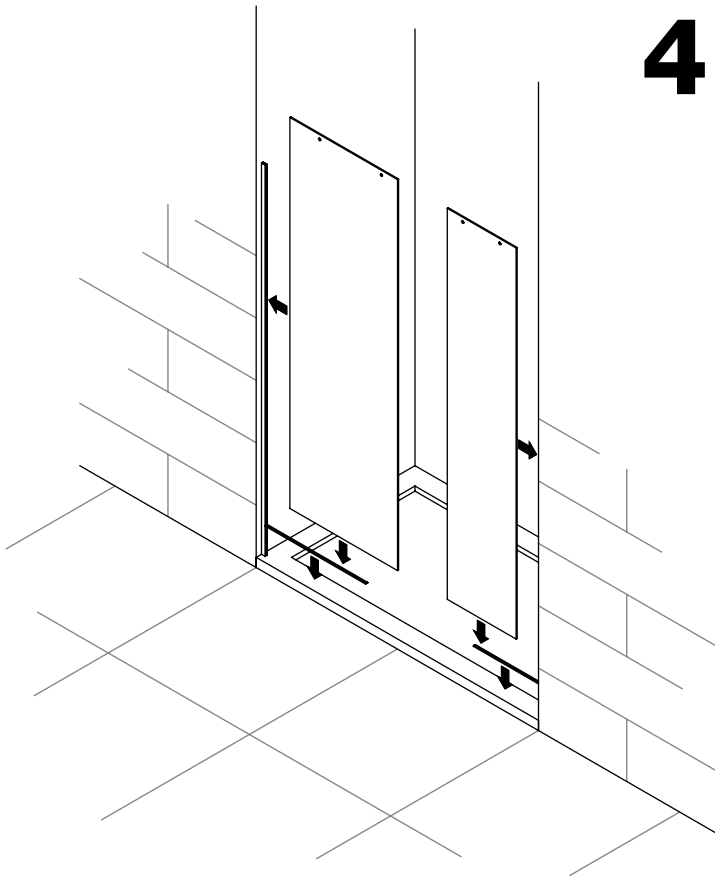

5

Fixer les verres fixes avec les joints et installer le guide inférieur à l'extrémité du verre.

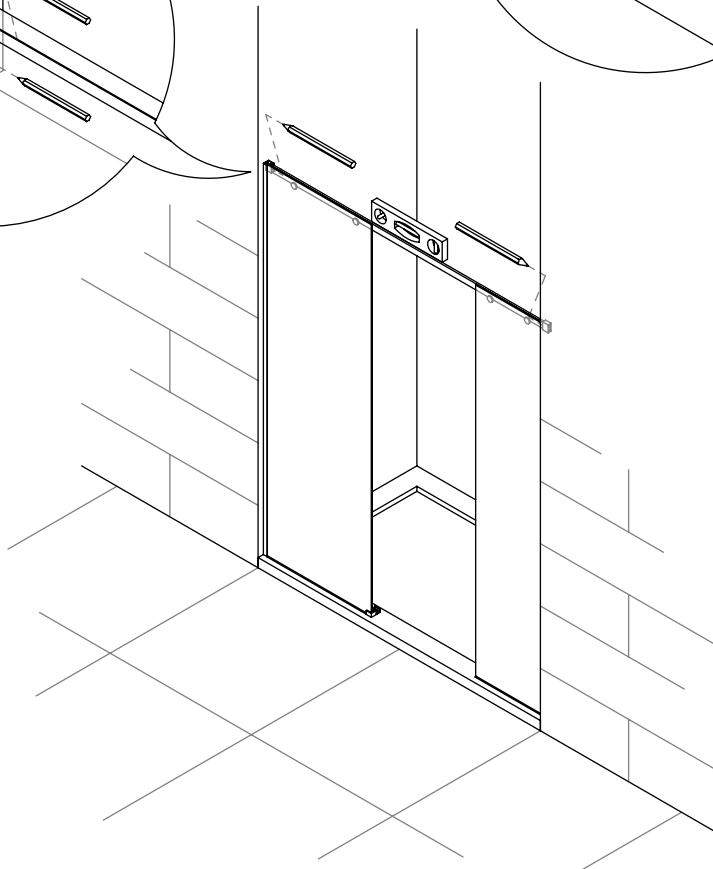

6

Présenter le profilé supérieur sur le verre fixe, ajuster les supports haut sans les serrer, mettre de niveau, tracer les percements et retirer le profilé.

Percer avec foret de 6mm

7

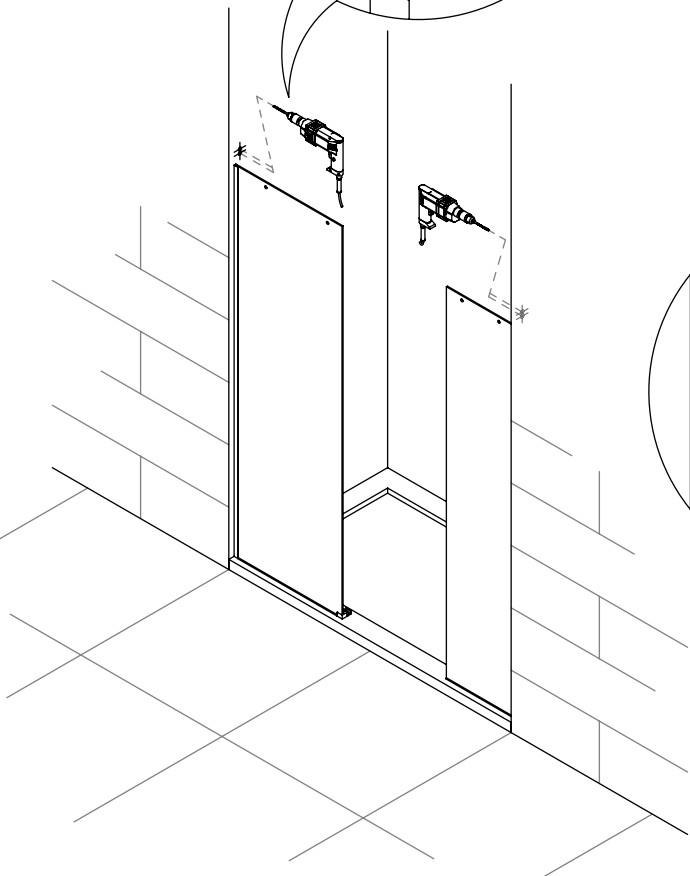
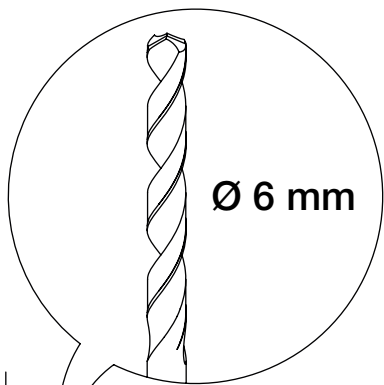

Visser le profilé supérieur

8

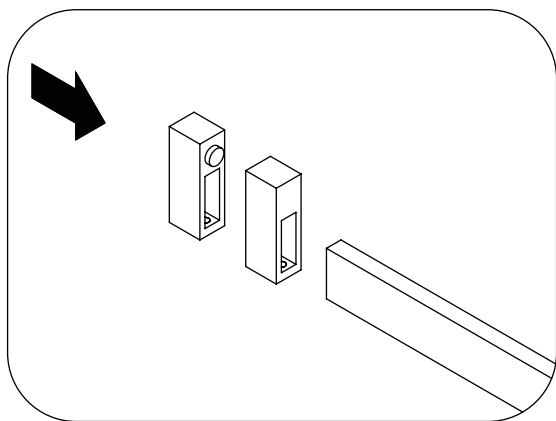
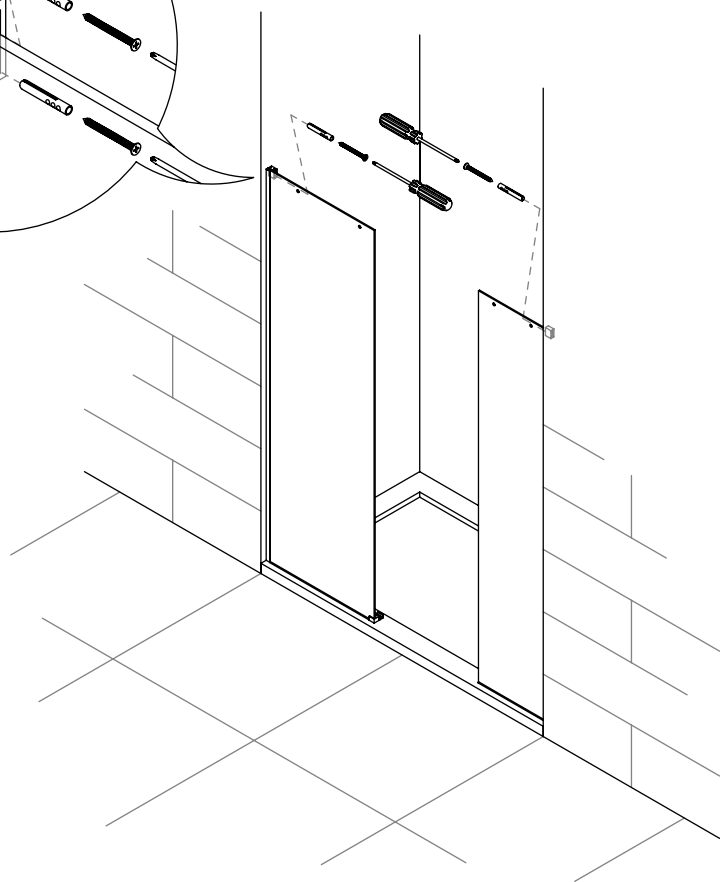
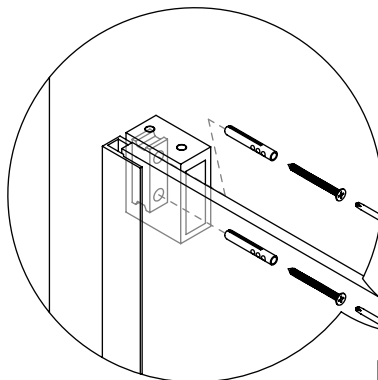

9

Introduire la buté dans le profilé.

10

Monter le verre fixe et le profilé sur les supports muraux

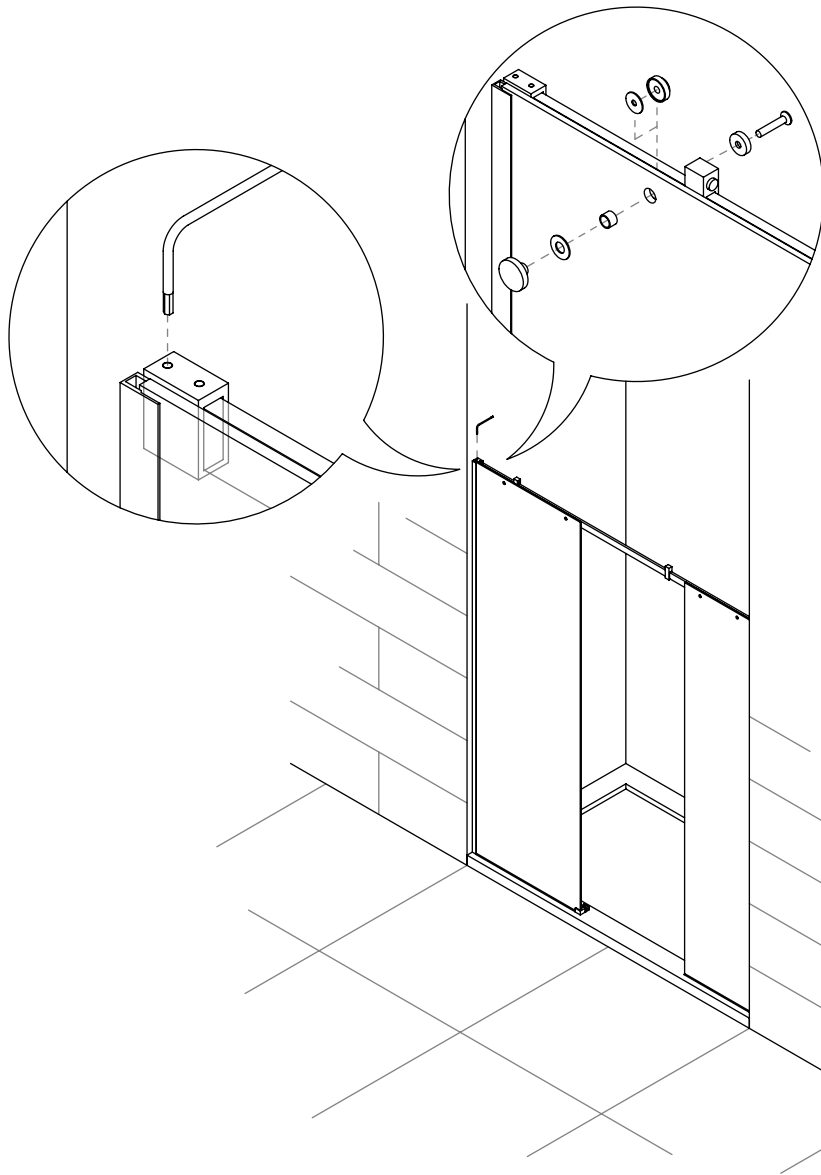

Régler l'aplomb du verre avec les roulements excentriques

11

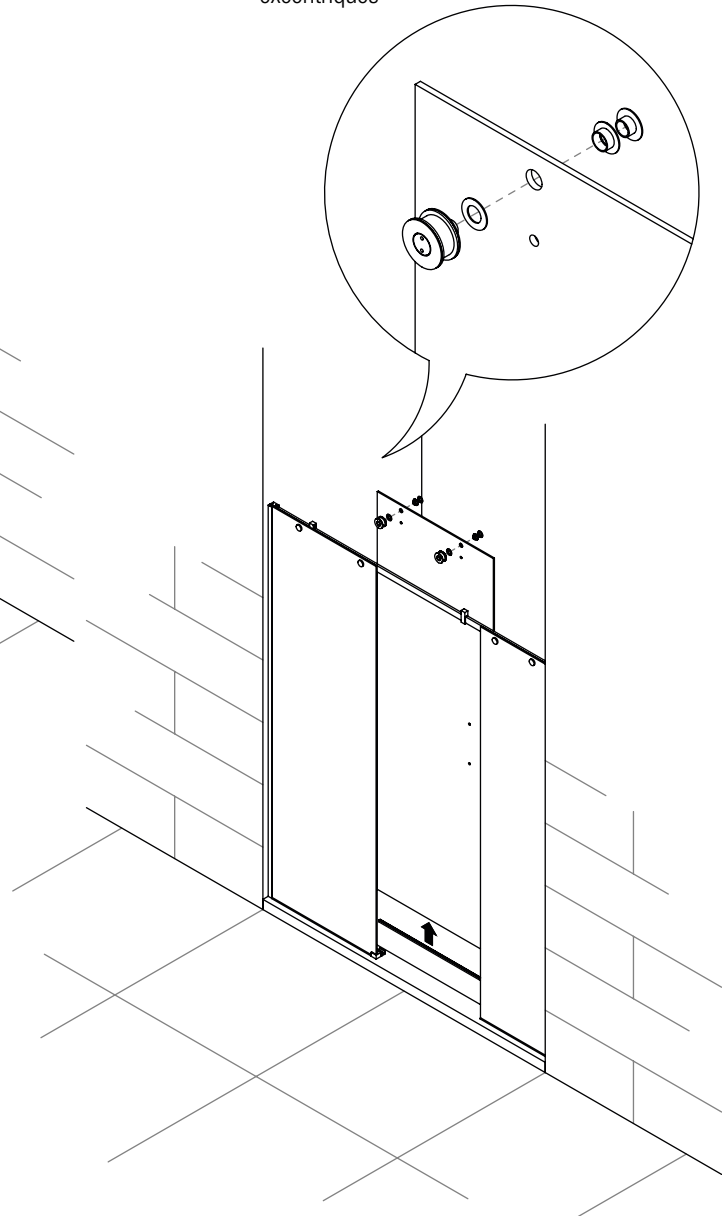

12

Monter les joints verticaux et le joint bulle sur le verre coulissant côté fermeture

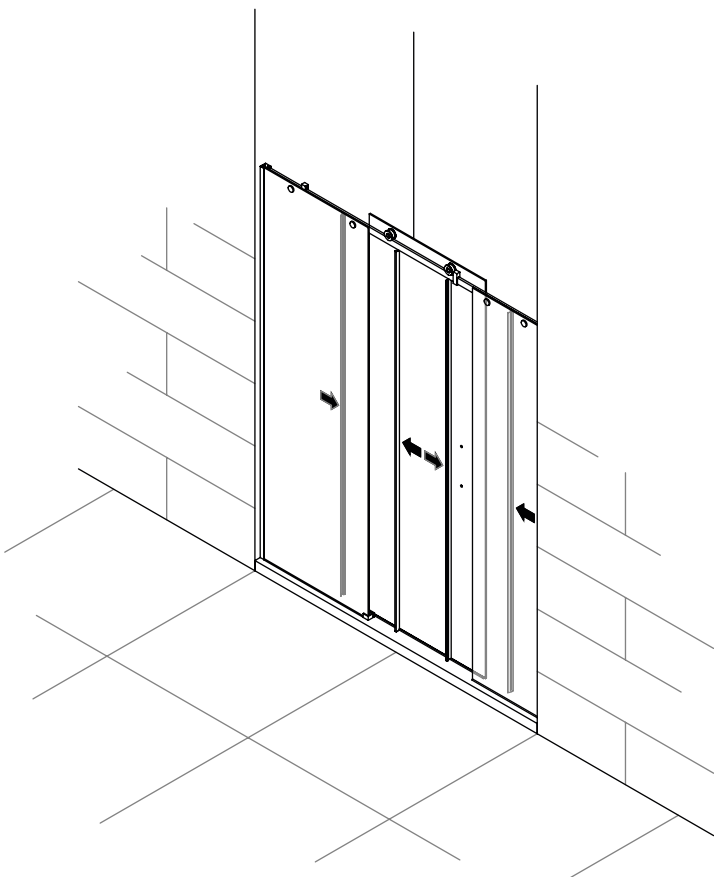

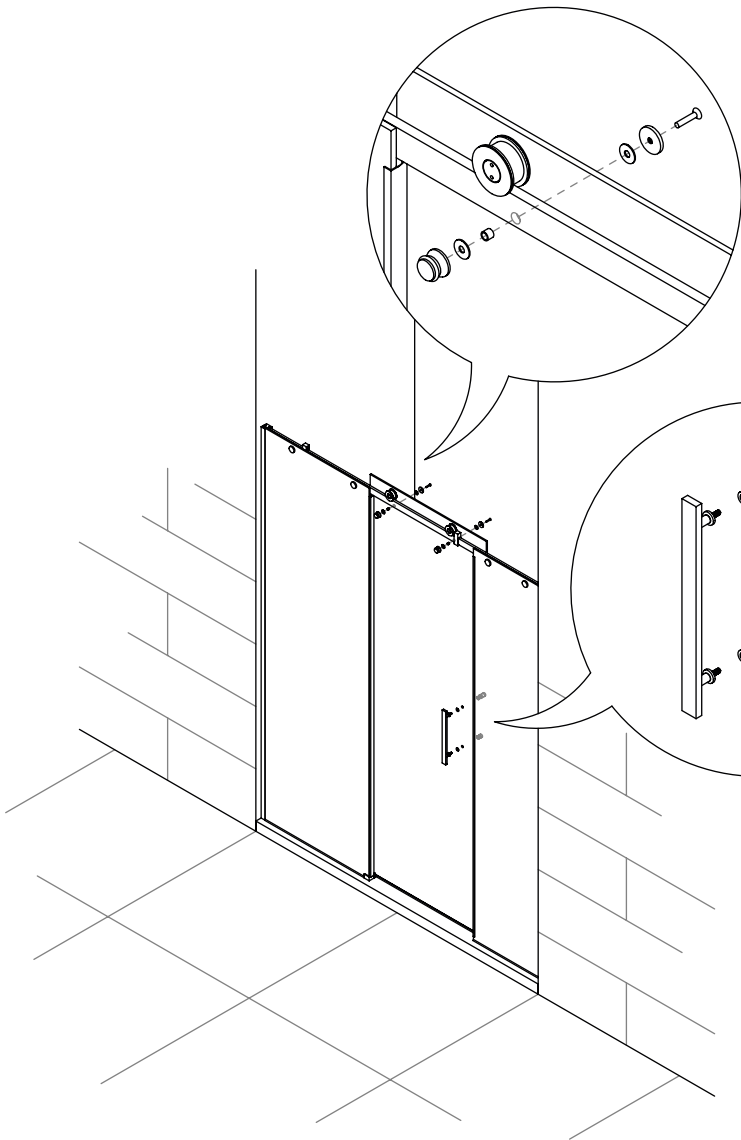

13 Ajuster les boulons anti-bascule et monter la poignée

fixer la butée.

14

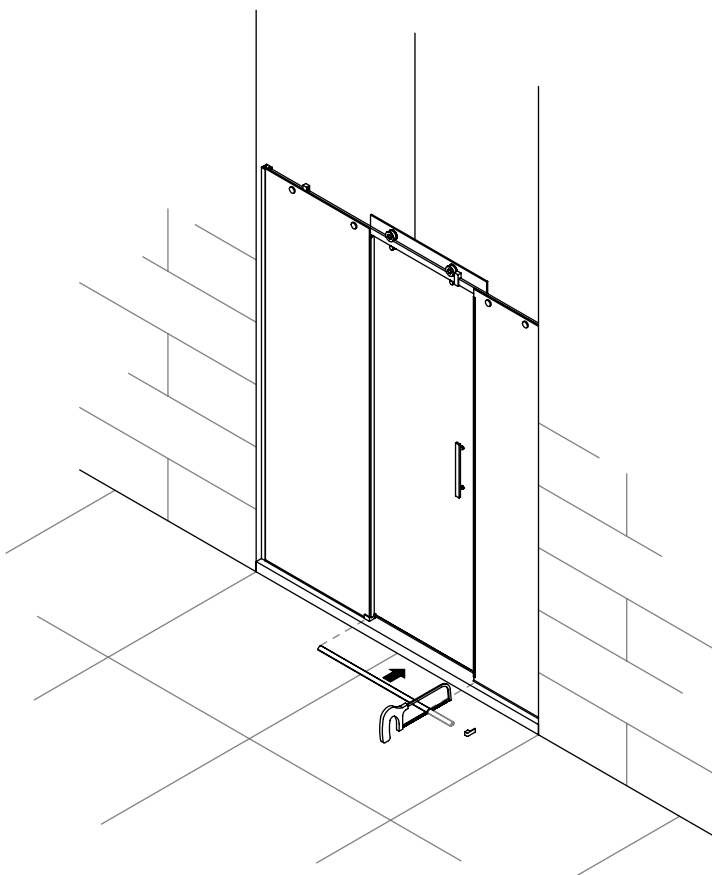
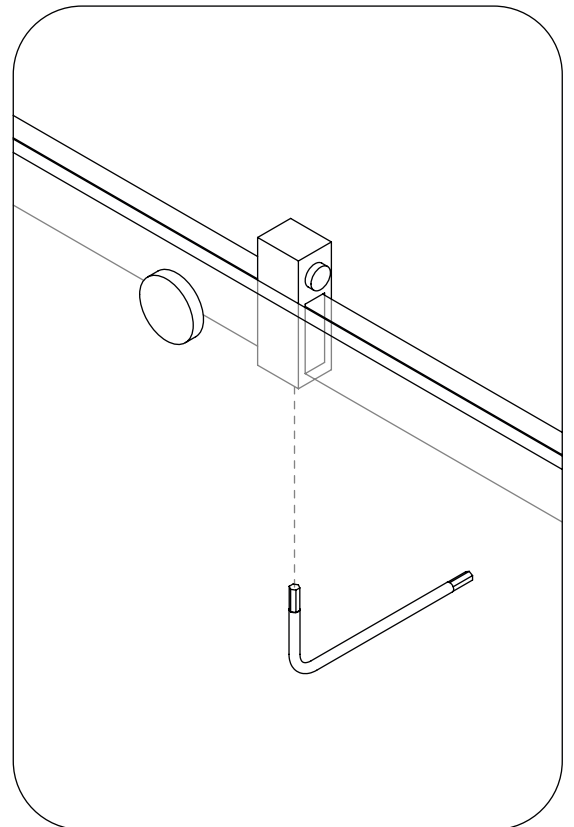

15 Couper et installer le profilé bas d'étanchéité à la mesure

16

Siliconer le profilé
d'étanchéité
à l'intérieur et à l'extérieur

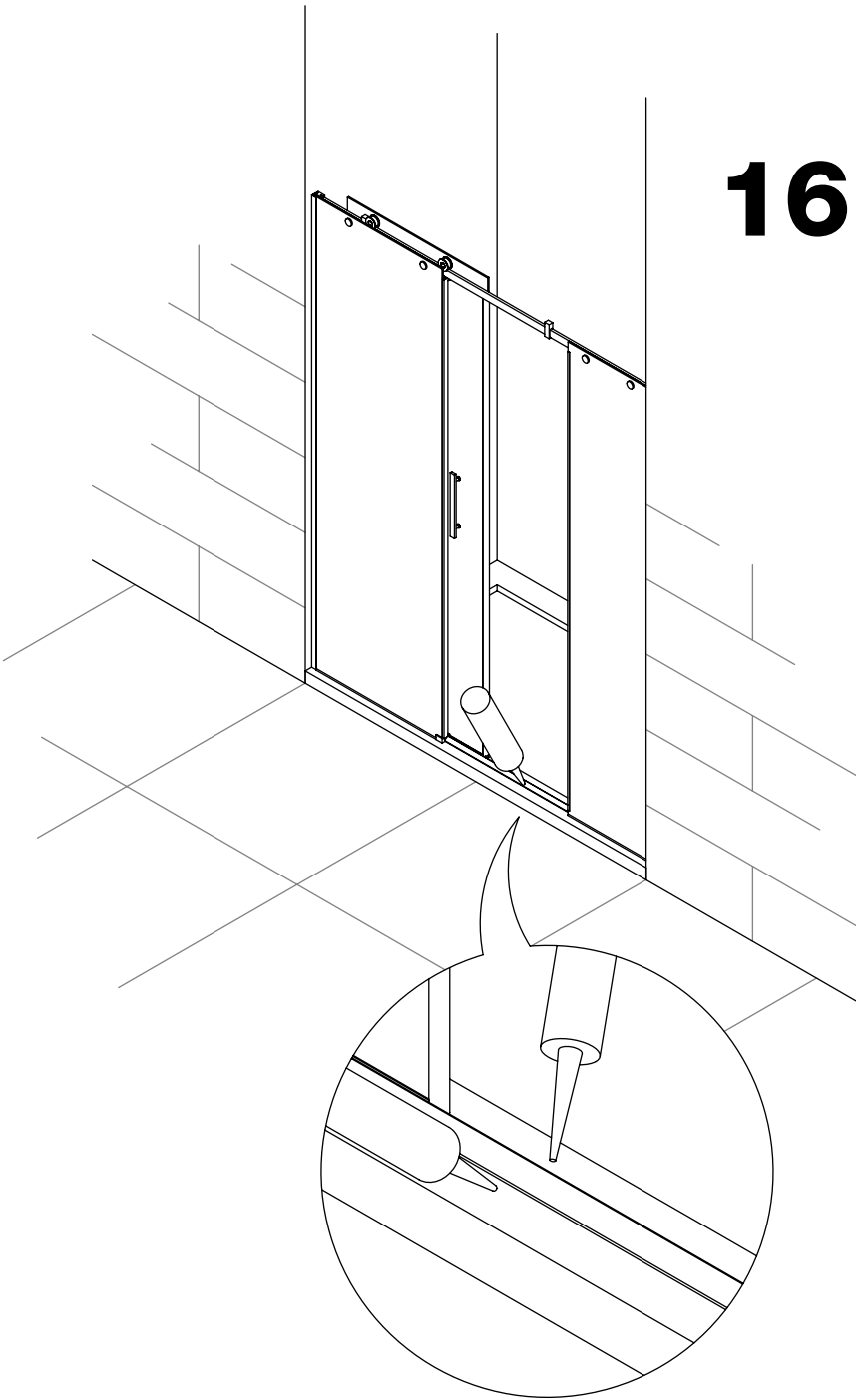

Siliconer à l'intérieur
le contour de la paroi.

17

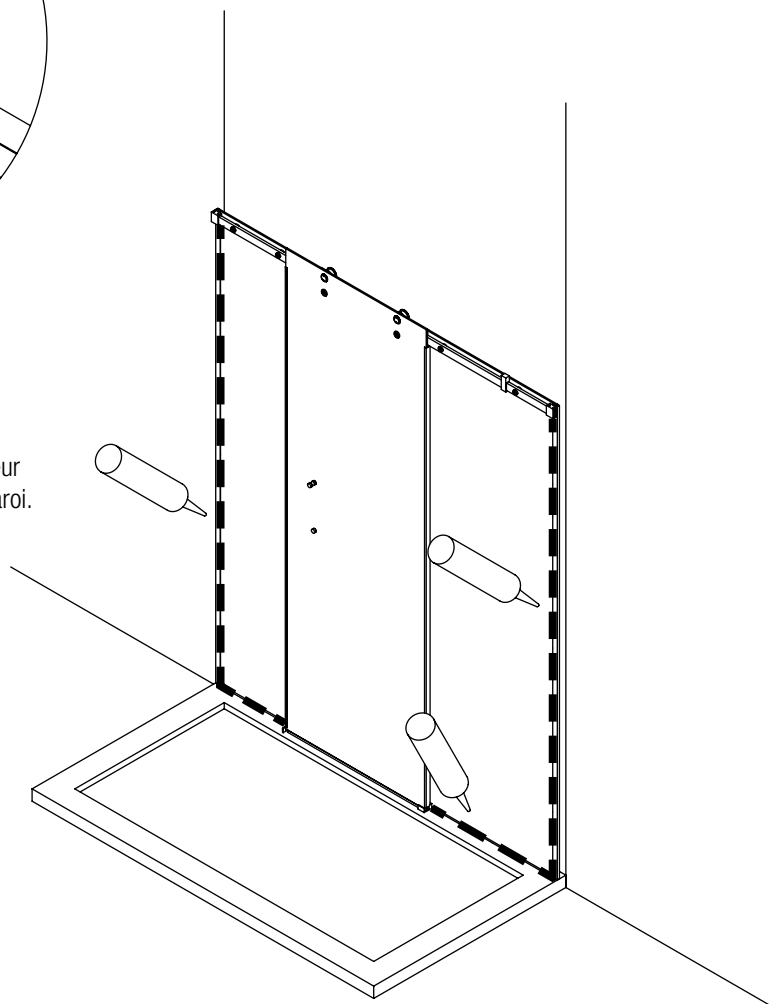

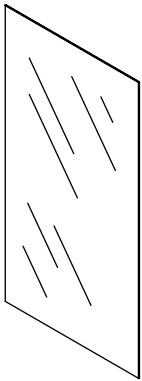
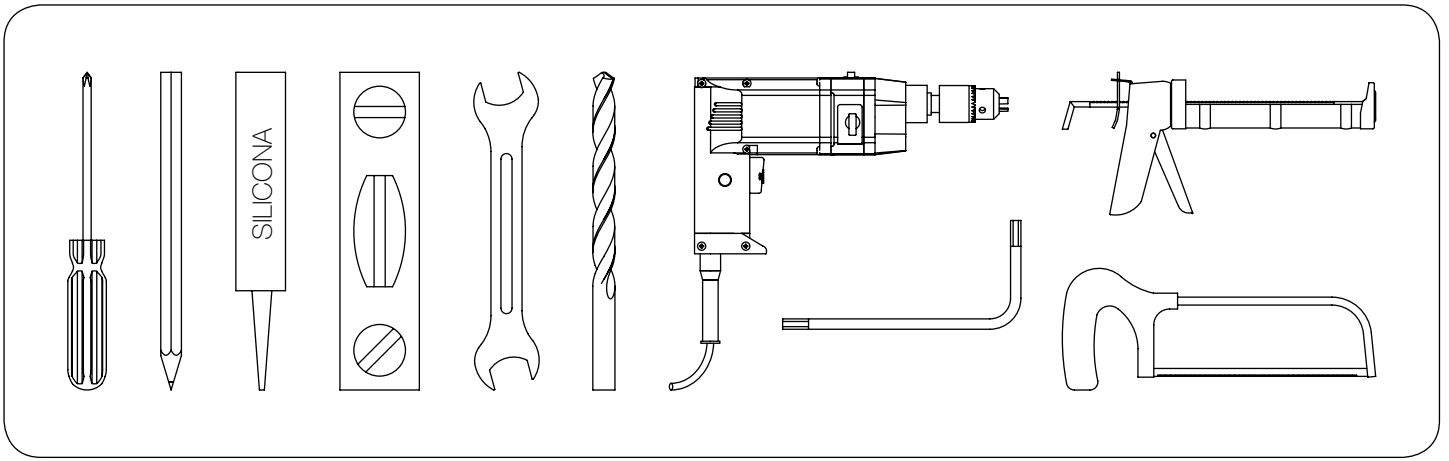

2x
verre fixe

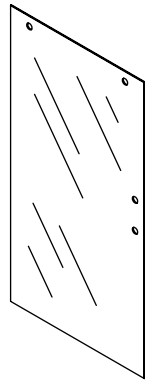

1x
verre coulissant

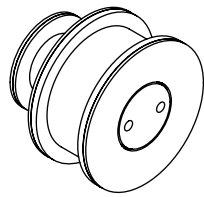

2x
roulements acier inoxydable

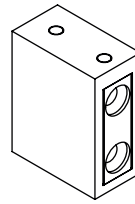

2x
support mural

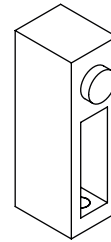

2x
buté intérieur profilé

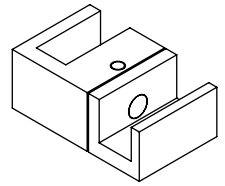

1x
guide inférieur

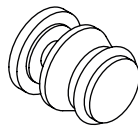

2x
boulon anti-bascule

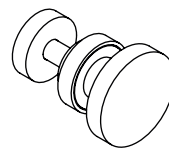

4x
fixation fixe/profilé

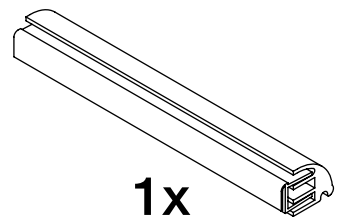

1x
profilé bas d'étanchéité

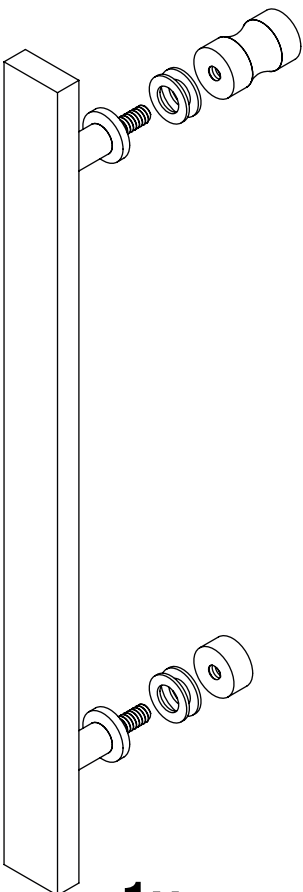

1x
poignée

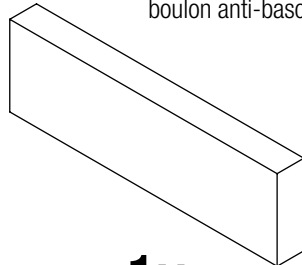

1x
profilé supérieur

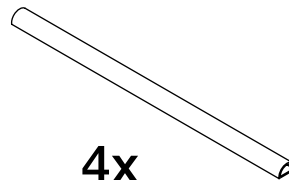

4x
bandes inférieures des fixes

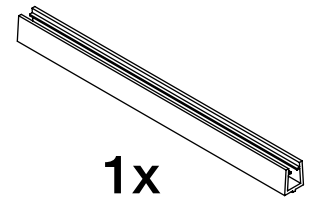

1x
joint bas de verre coulissant

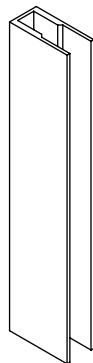

2x
profilé du fixe

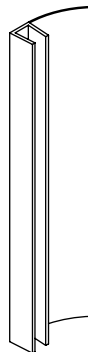

4x
joint vertical
fixe/coulissant

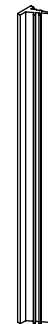

2x
joint verre fixe

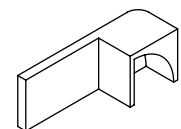

1x
enjolveur profilé bas



10x
chevilles n°6

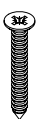

10x
vis 4,2 x 32

instructions effectuées par:



www.ar3d.es