

# MUSEO

## PAROIS DE DOUCHE

ANGLE:

1 PORTE BATTANTE / 1 LATERAL FIXE

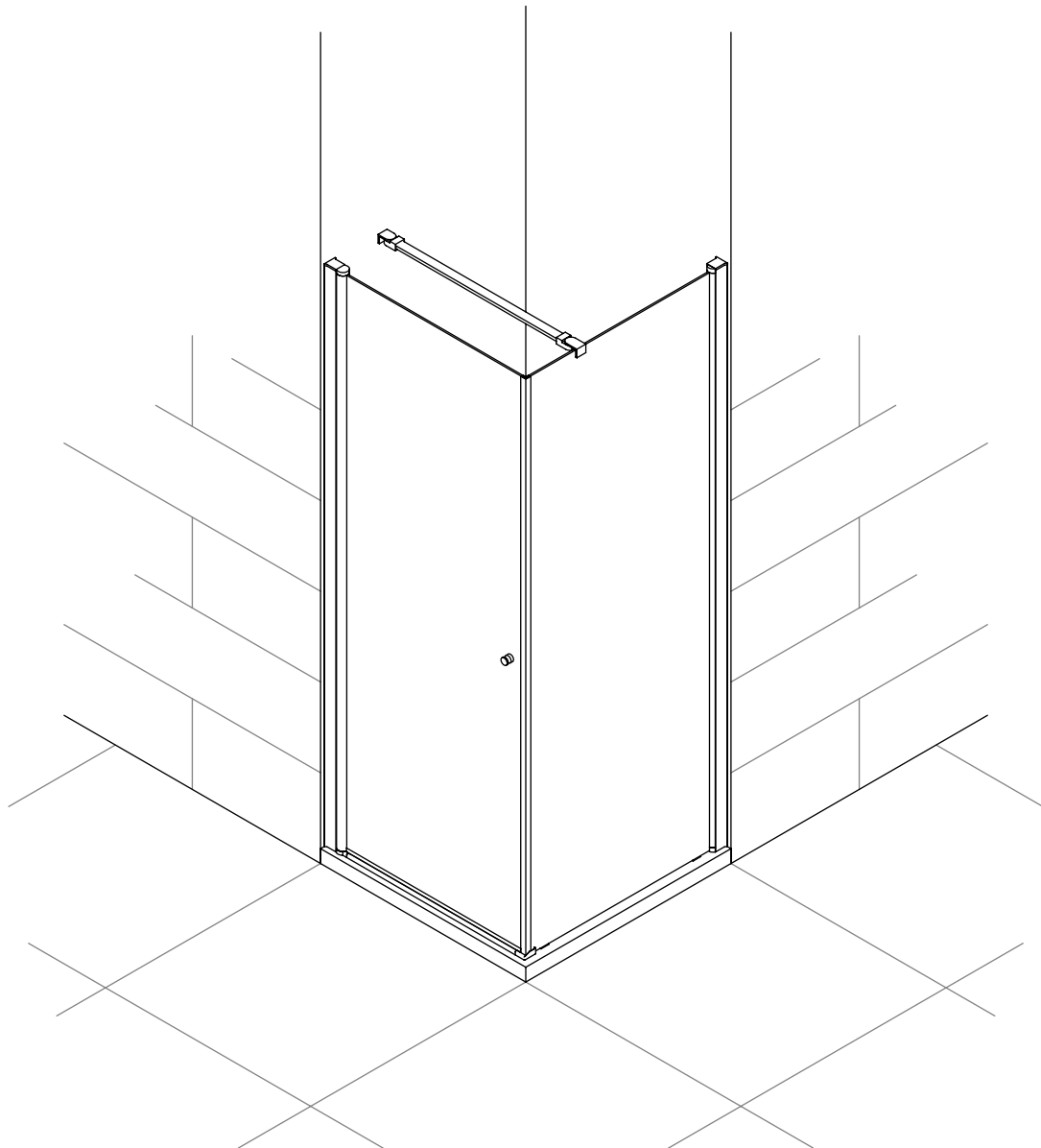

LERAC DIFFUSION

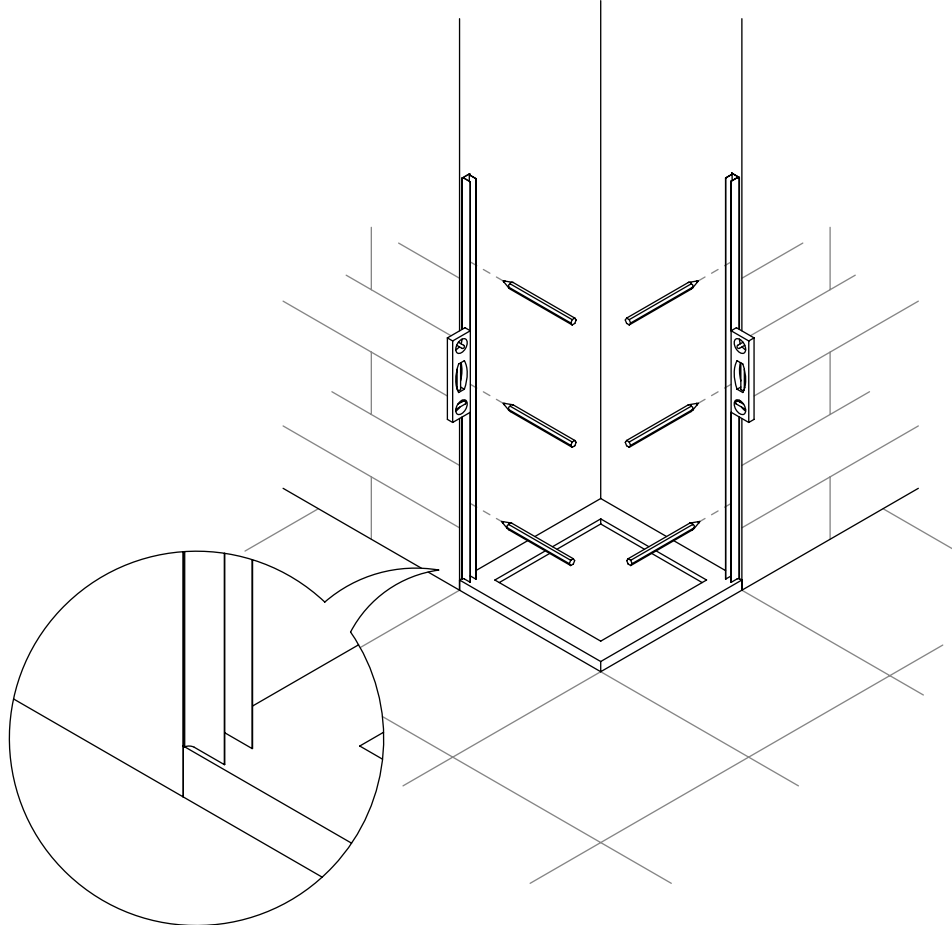

**1**

présenter les profilés aux murs  
tracer les perçages

**2**  
percer avec foret de 6mm

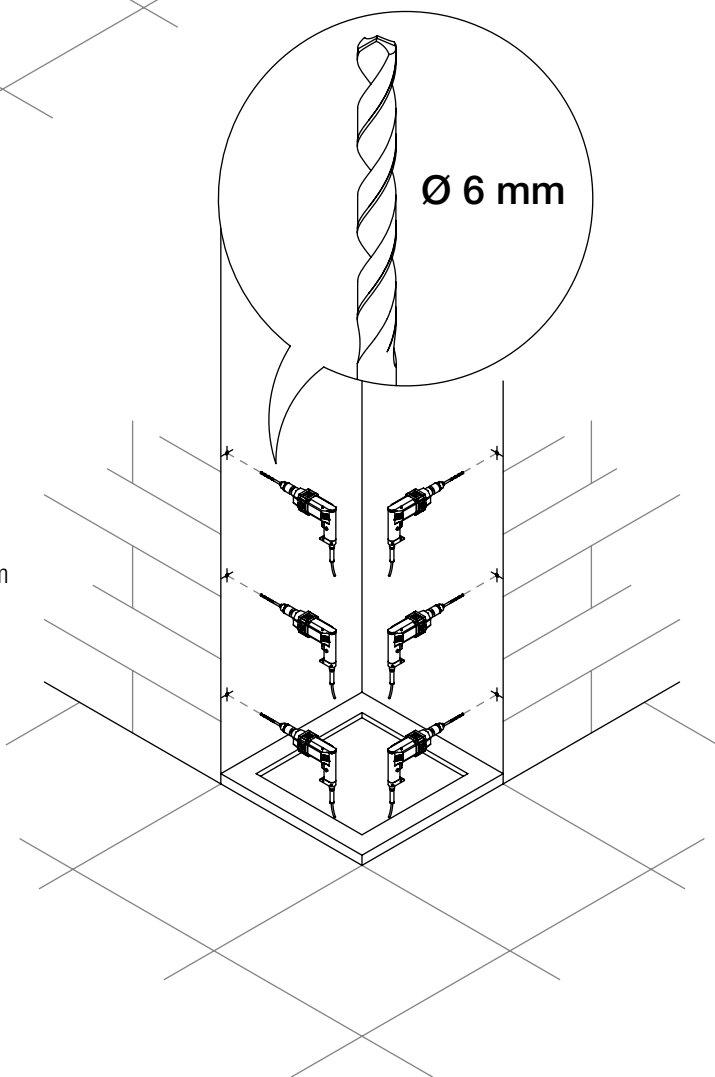

**3**

viser les profilés d'expansion  
aux murs avec chevilles n°6  
et vis 4,2x32

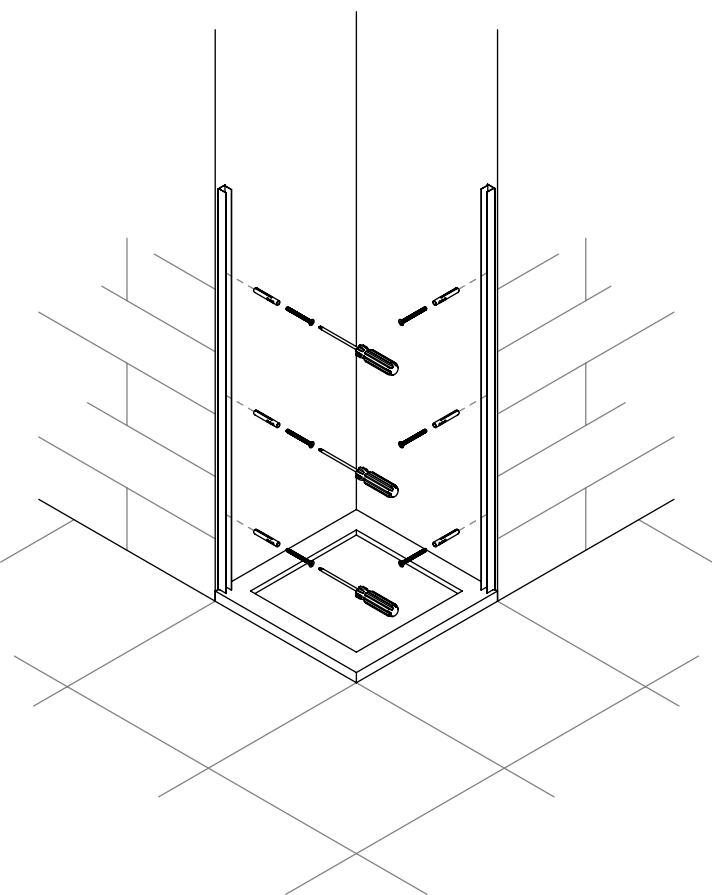

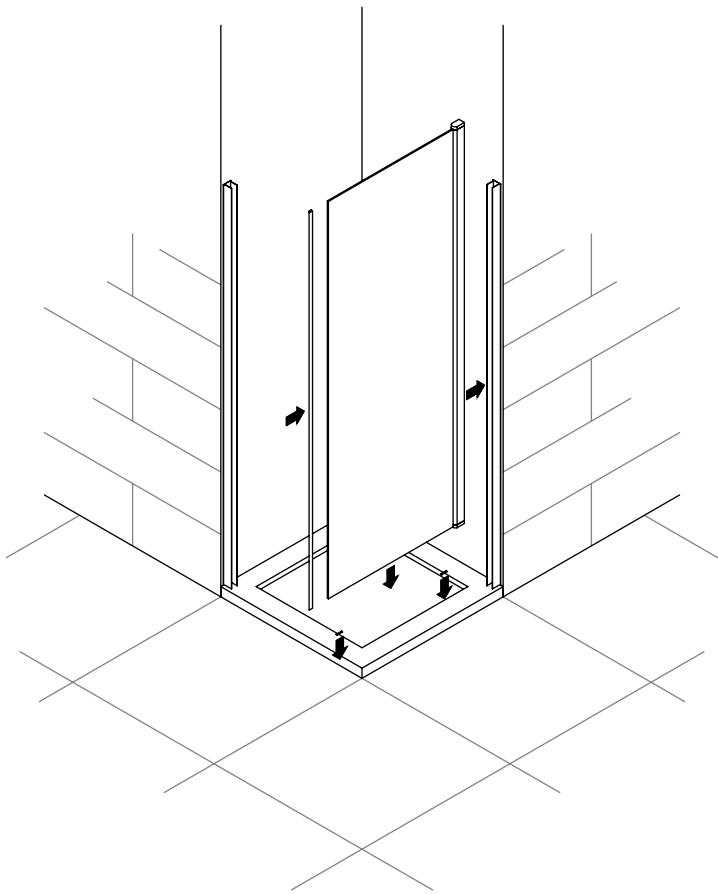

# 4

mettre les bandes adhésives  
sur le receveur  
introduire le latéral fixe  
en reposant sur celles-ci  
mettre l'aimant sur le verre fixe

# 5

mettre les cales sous la  
porte battante  
monter l'aimant sur la porte

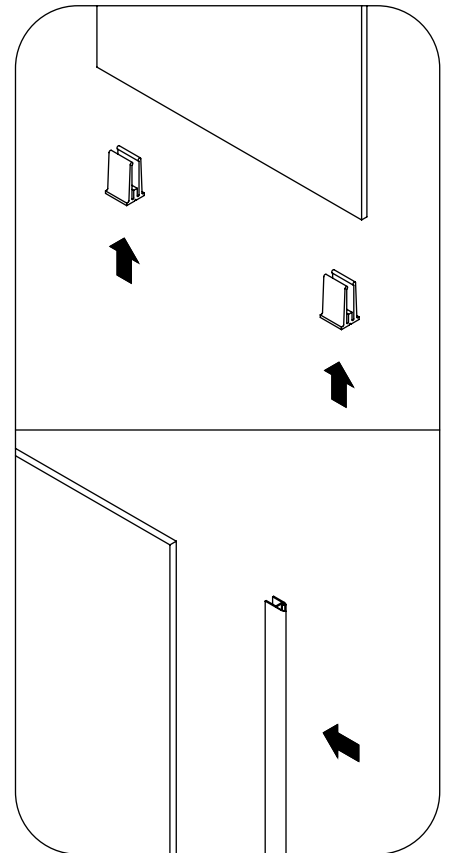
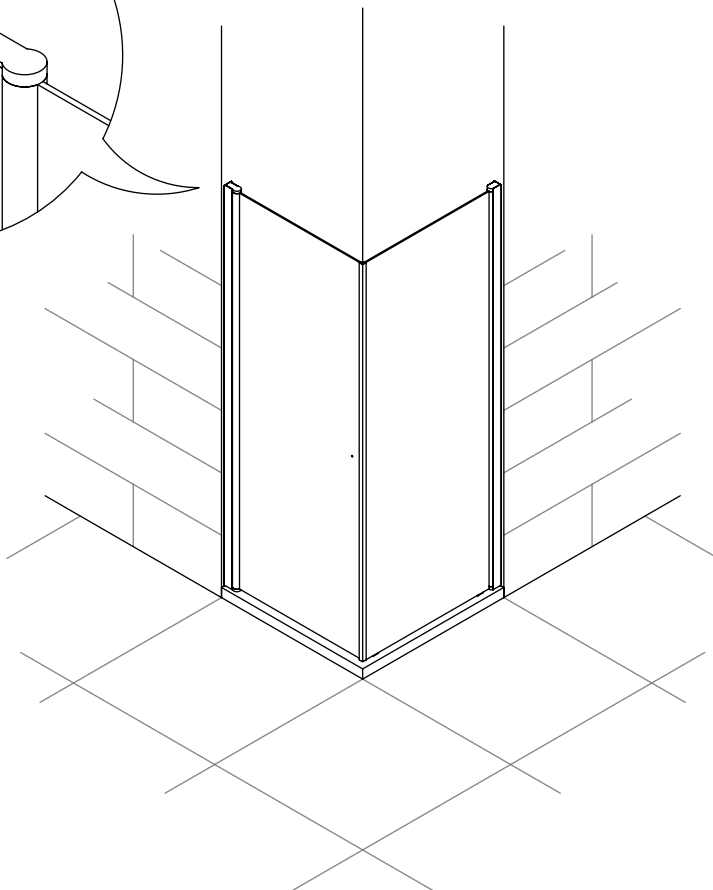
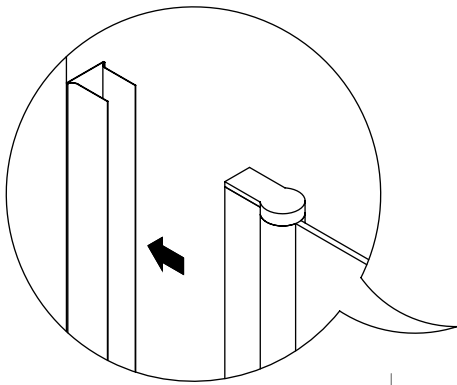

# 6

introduire la porte dans le profilé

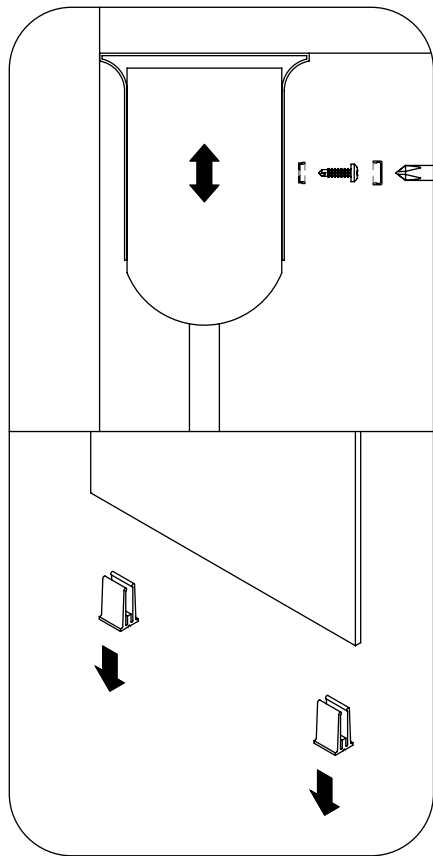

# 7

faire coïncider les aimants  
en réglant le latéral fixe  
viser et retirer les cales

# 8

installer les terminaisons  
du profilé bas  
couper le profilé à la dimension  
entre les terminaisons  
installer le bras support

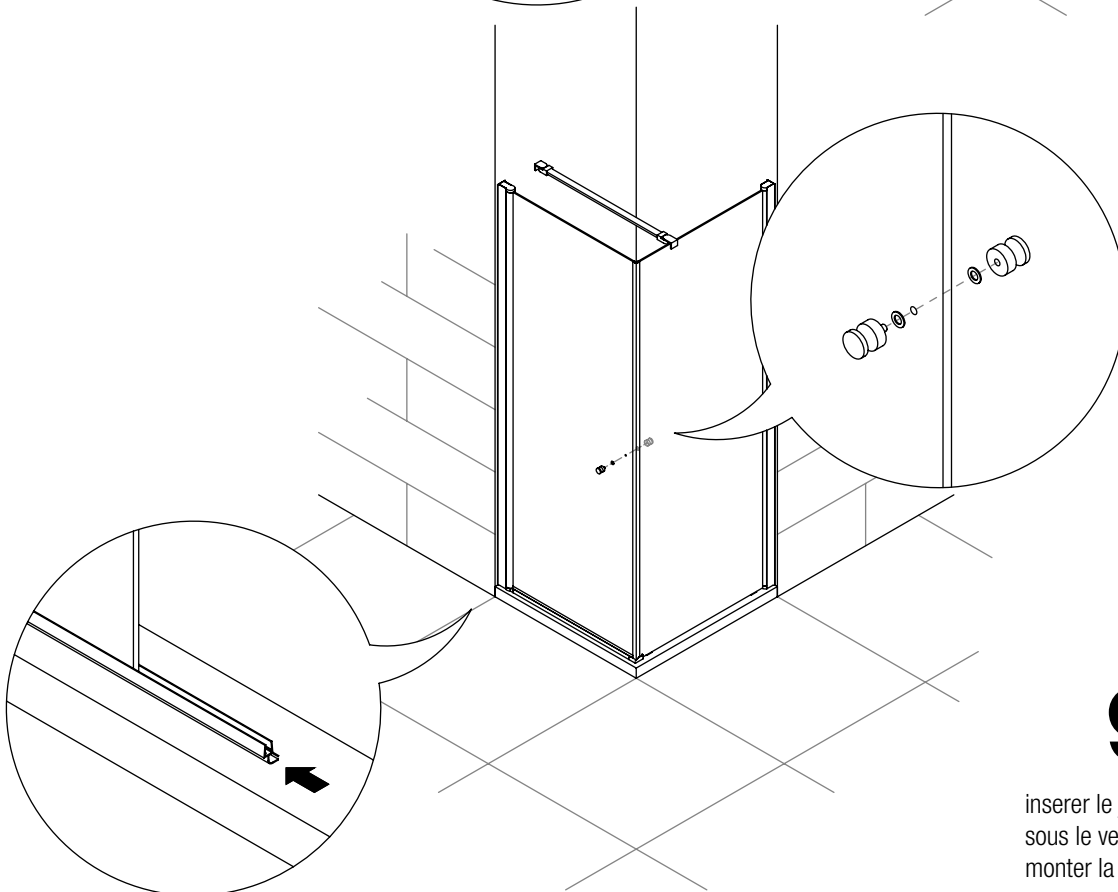
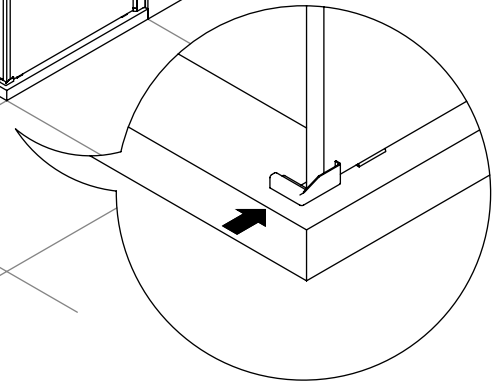
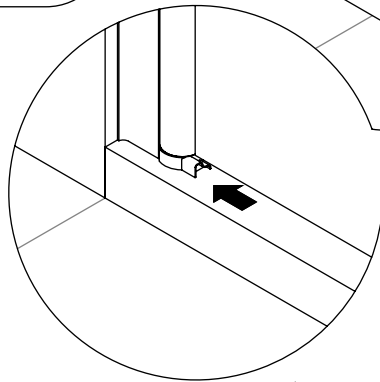
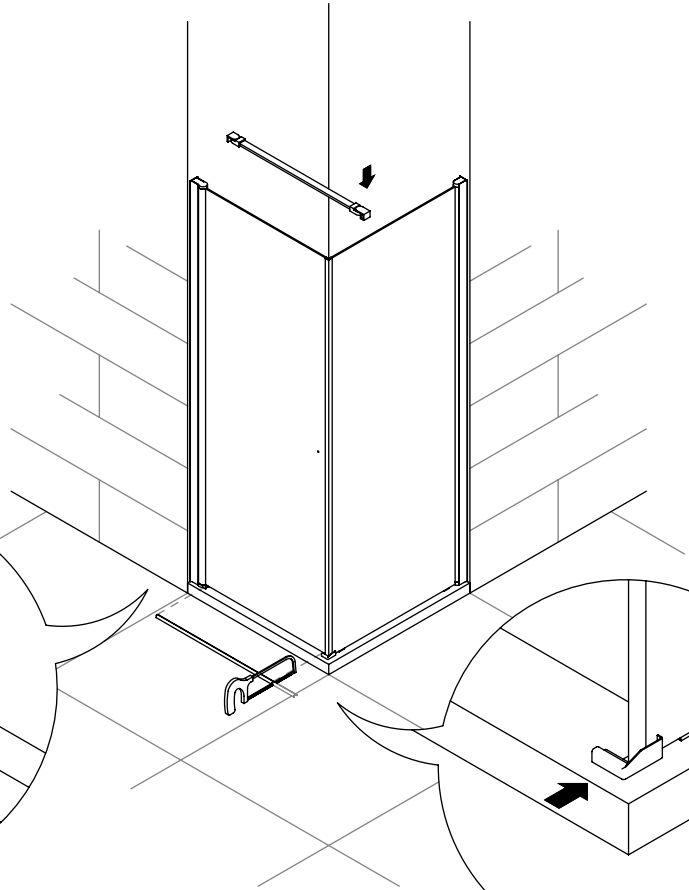

# 9

insérer le joint inférieur  
sous le verre de la porte  
monter la poignée

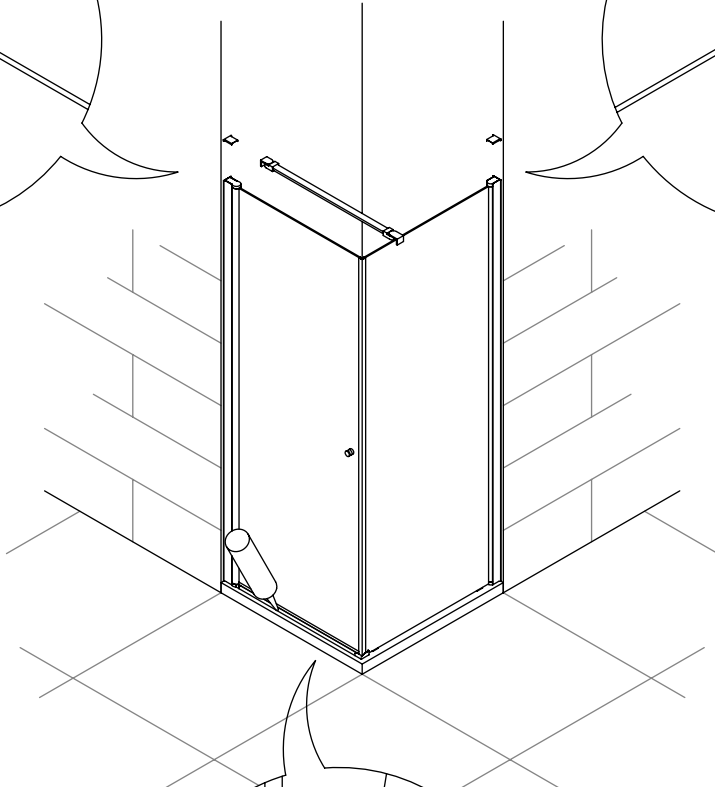
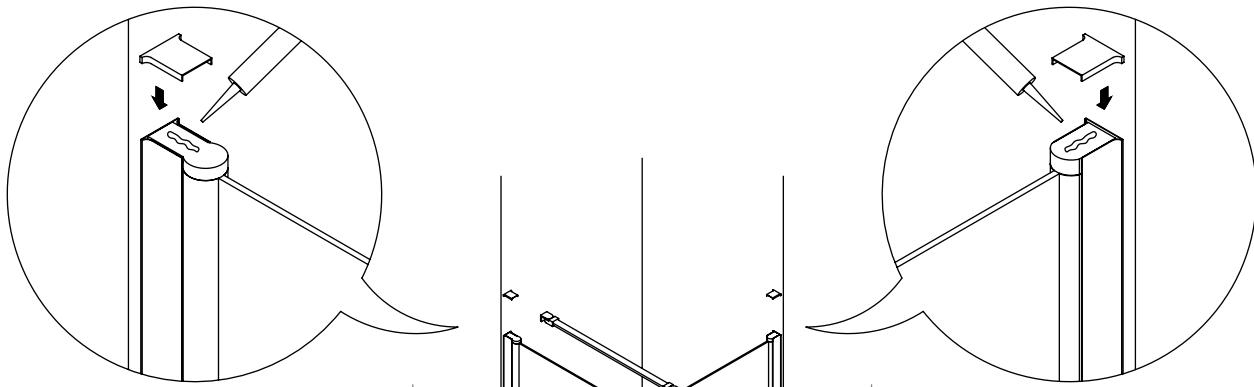

**10**

coller le cache supérieur  
siliconer le profilé bas  
devant et derrière

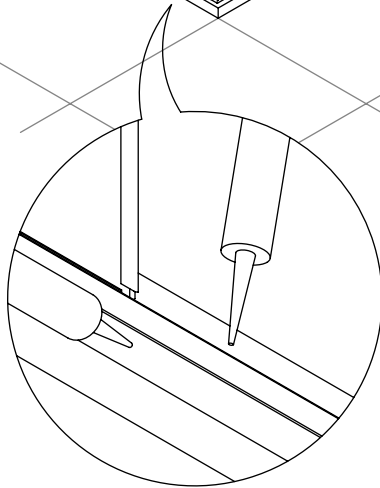

**11**

siliconer le contour  
intérieur du fixe

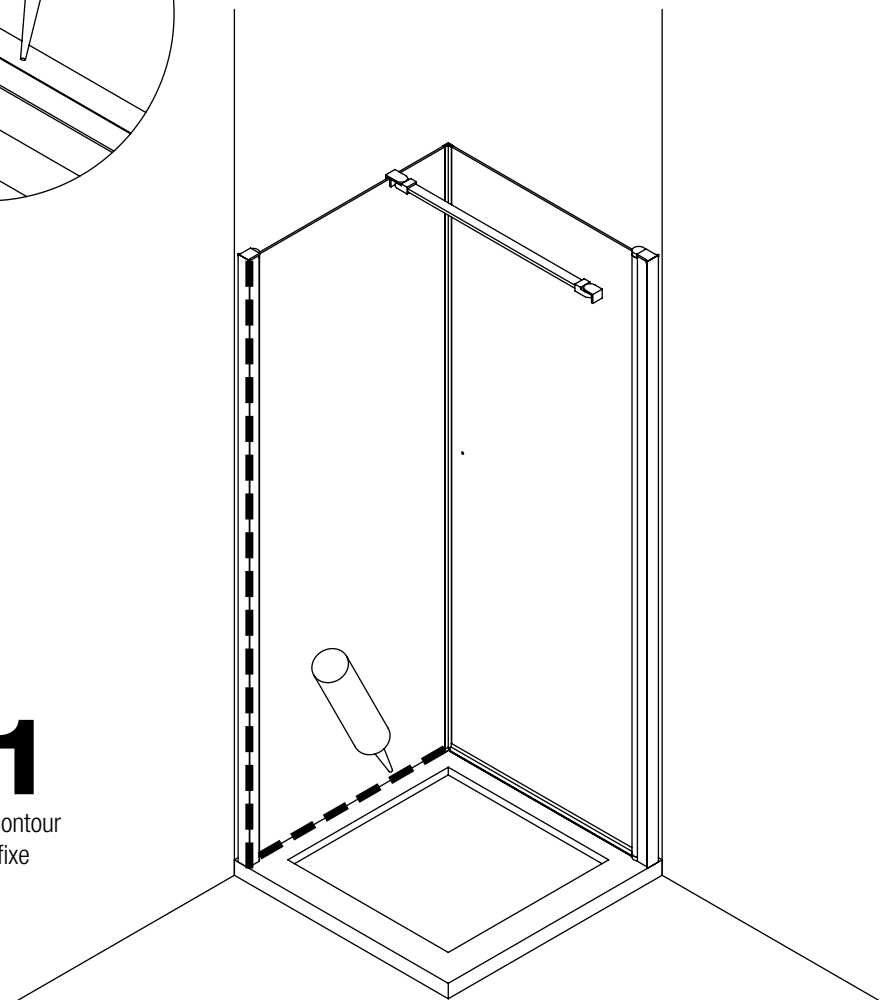

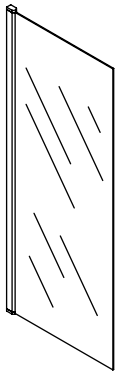
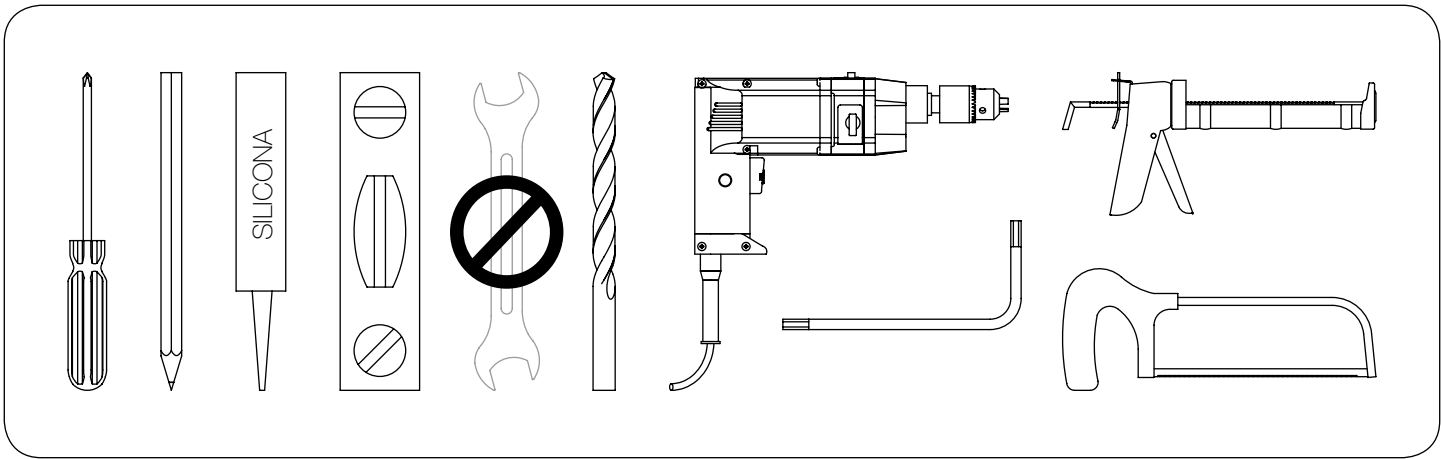

**1x**  
verre fixe

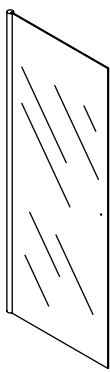

**1x**  
verre porte

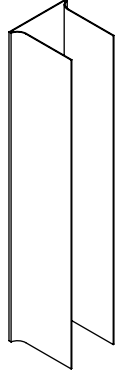

**2x**  
profilé porte

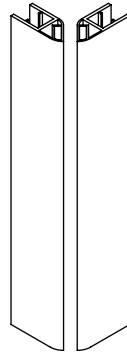

**1x**  
joint aimant

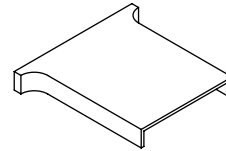

**2x**  
cache supérieur porte

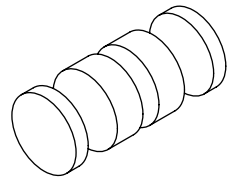

**1x**  
poignée

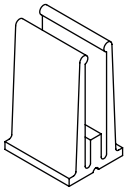

**2x**  
cale

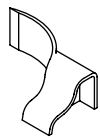

**1x**  
terminaison profilé bas

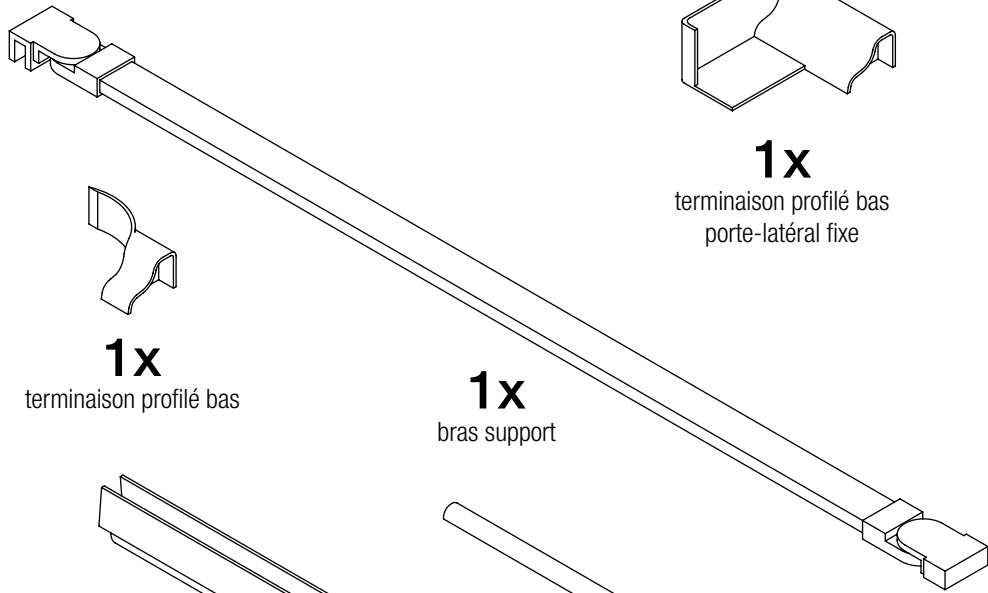

**1x**  
bras support

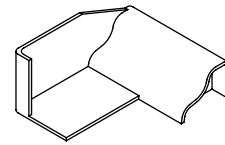

**1x**  
terminaison profilé bas  
porte-latéral fixe

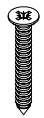

**7x**  
vis 4,2x32

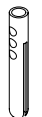

**7x**  
cheville

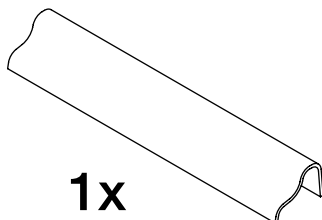

**1x**  
profilé bas d'étanchéité

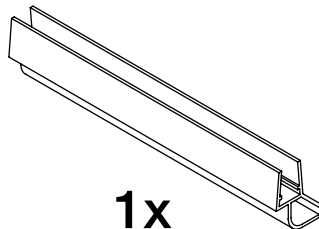

**1x**  
joint bas de porte

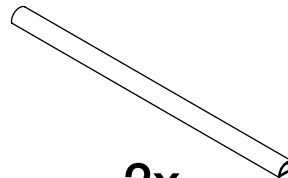

**2x**  
bandes adhésives  
inférieures du fixe



**4x**  
vis expansion

instructions effectuées par:



www.ar3d.es