

IRIDIUM

PAROIS DE DOUCHE

ACCES D'ANGLE:
2 FIXES + 2 COULISSANTS

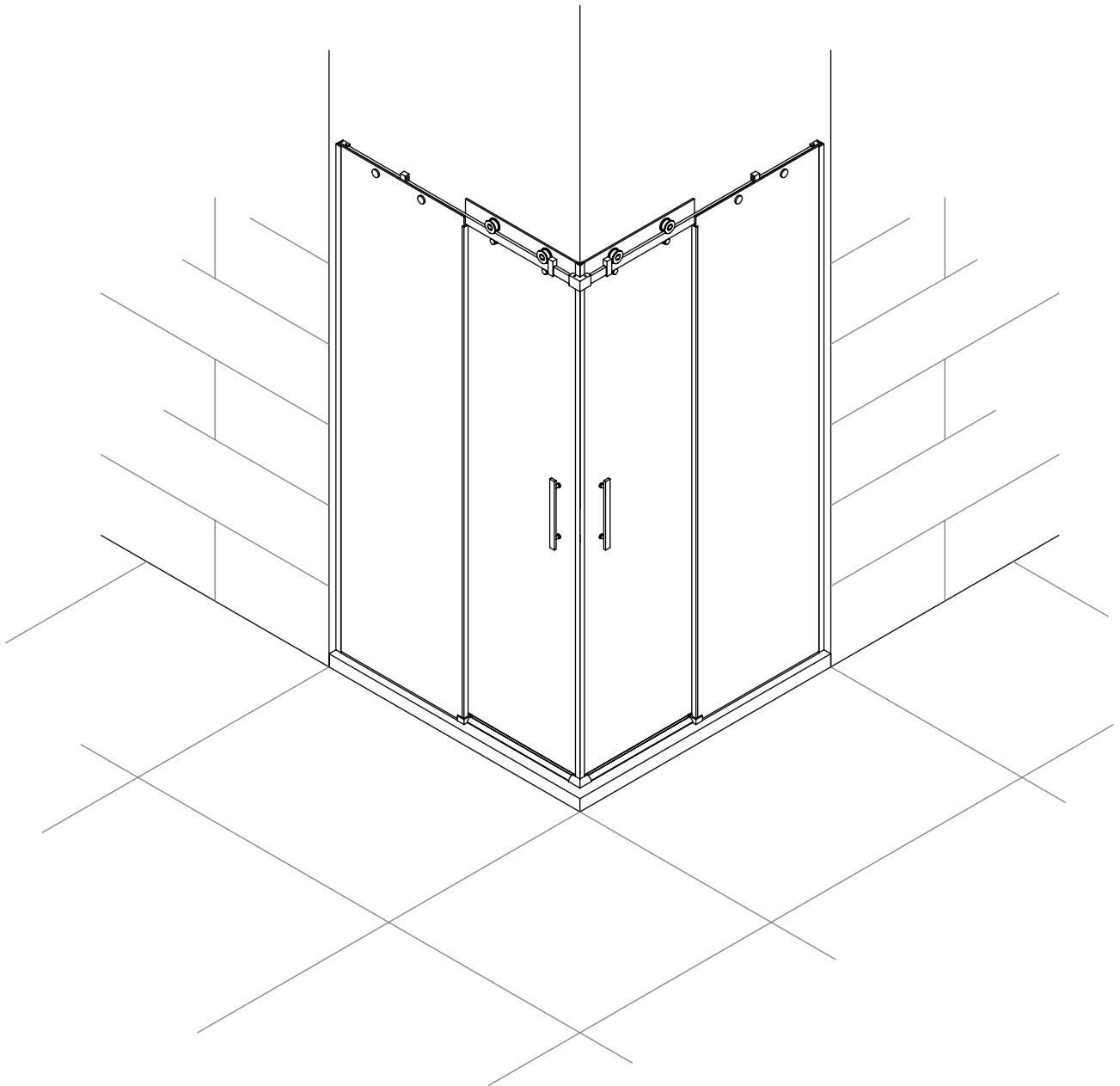

LERAC DIFFUSION

1

Présenter le profilé mural et tracer les perçages

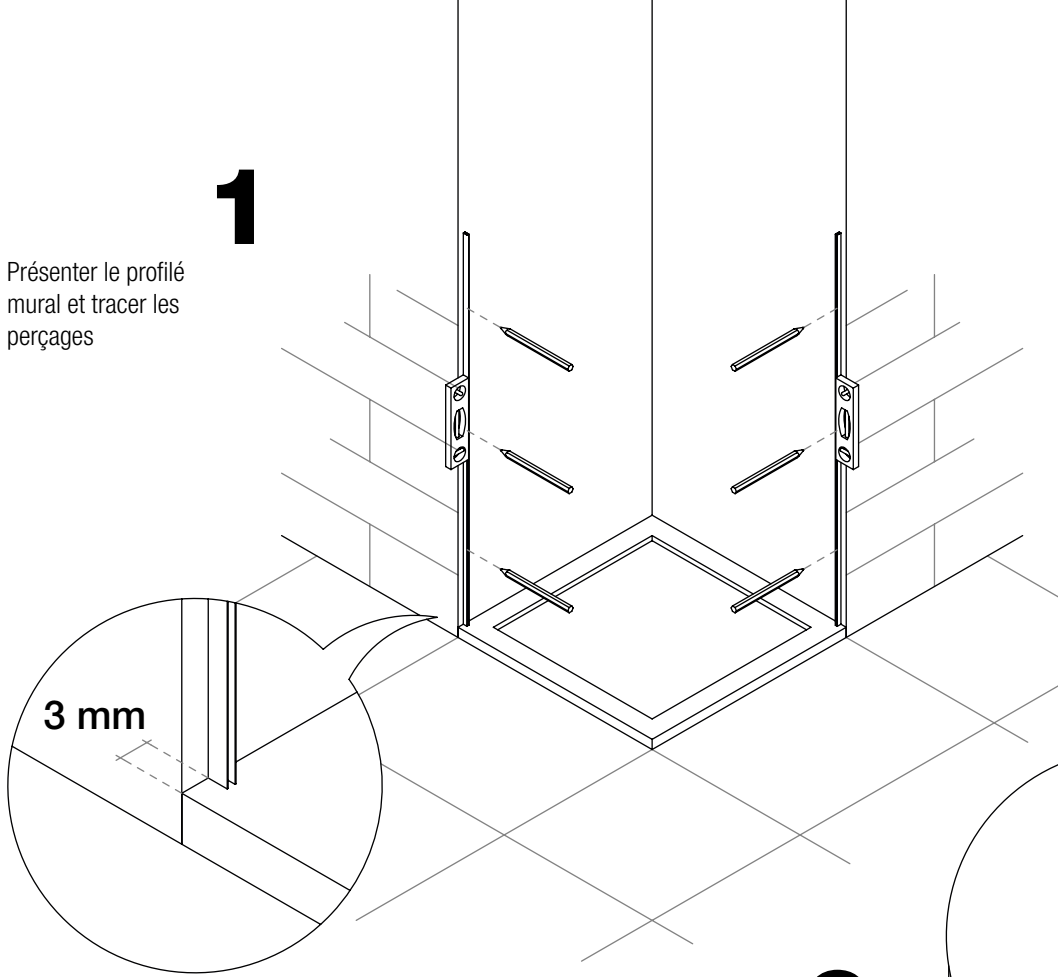

3 mm

2

Percer avec foret de 5mm

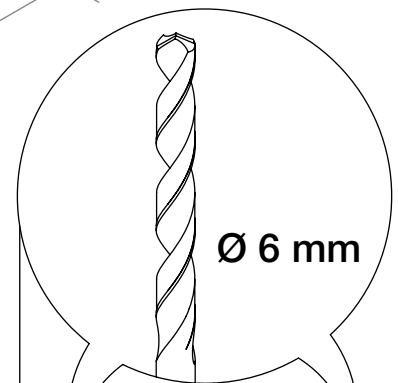

$\text{Ø } 6 \text{ mm}$

3

Viser le profilé au mur avec chevilles de 5 et vis de 3x30 de chaque côté.

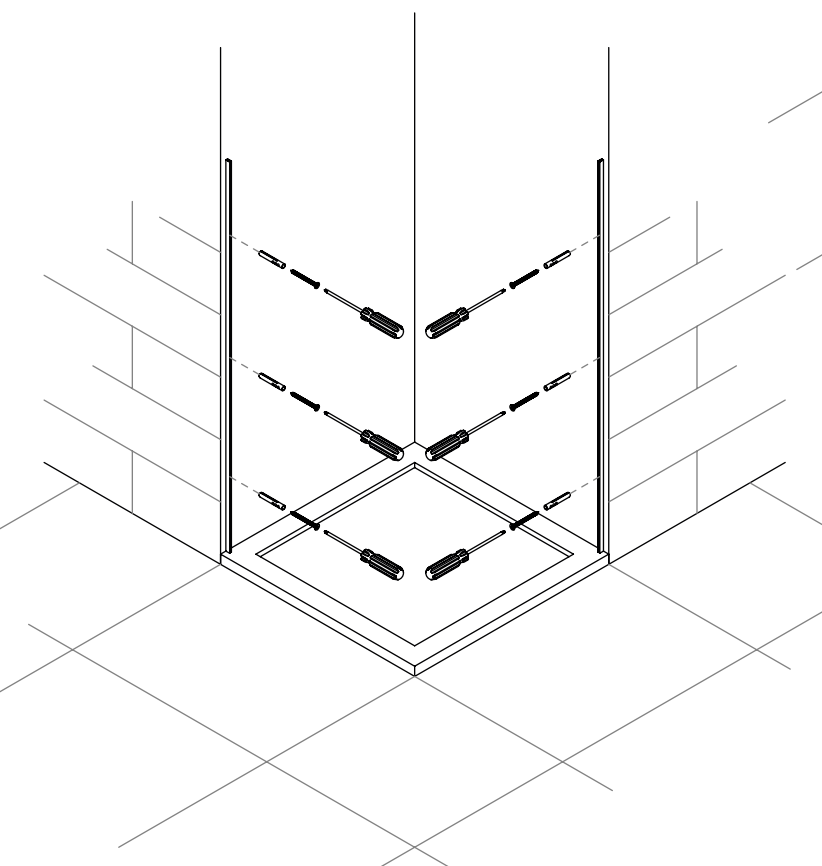

4 Positionner les bandes adhésives sur le receveur et introduire les 2 verres fixes dans les profilés en reposant sur les bandes.

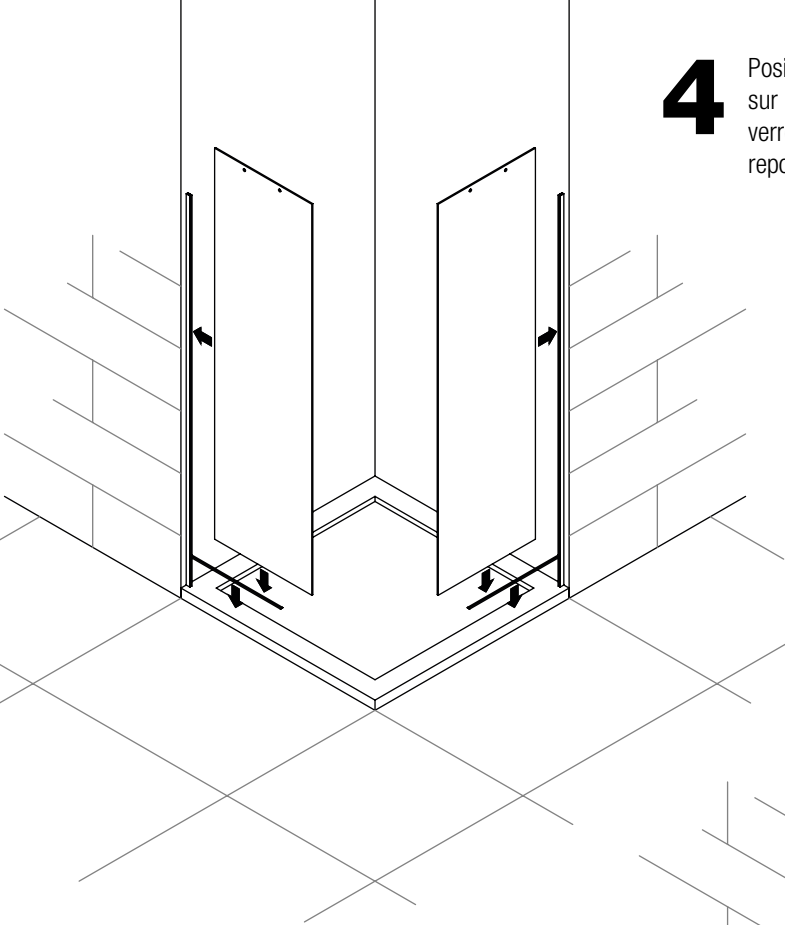

Fixer les verres fixes avec les joints et installer le guide inférieur à l'extrémité du verre.

5

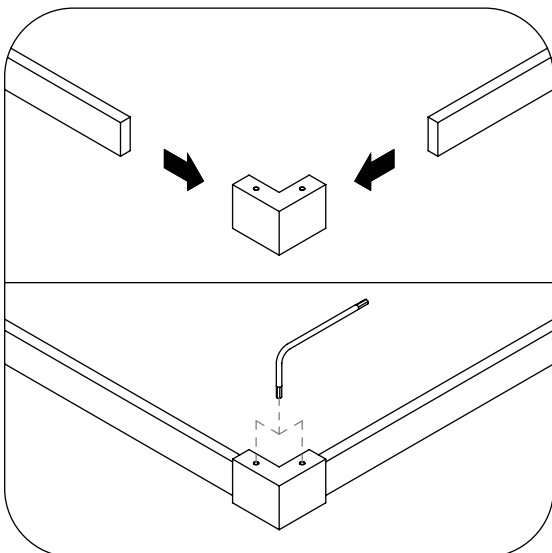
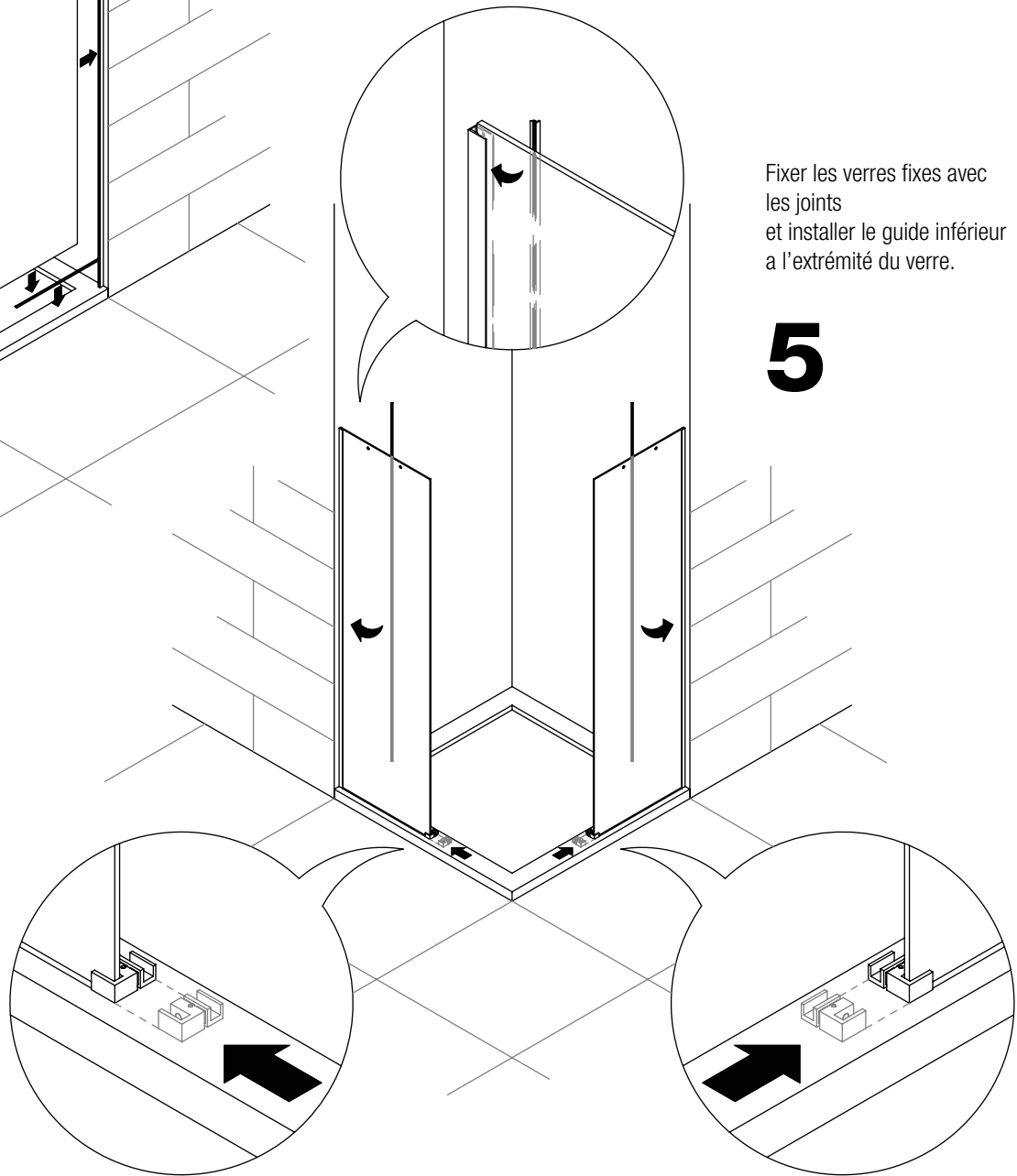

6

Unir les deux profilés haut avec le coude.

7 Présenter le profilé supérieur sur le verre fixe, ajuster les supports haut sans les serrés, mettre de niveau, tracer les percements et retirer le profilé.

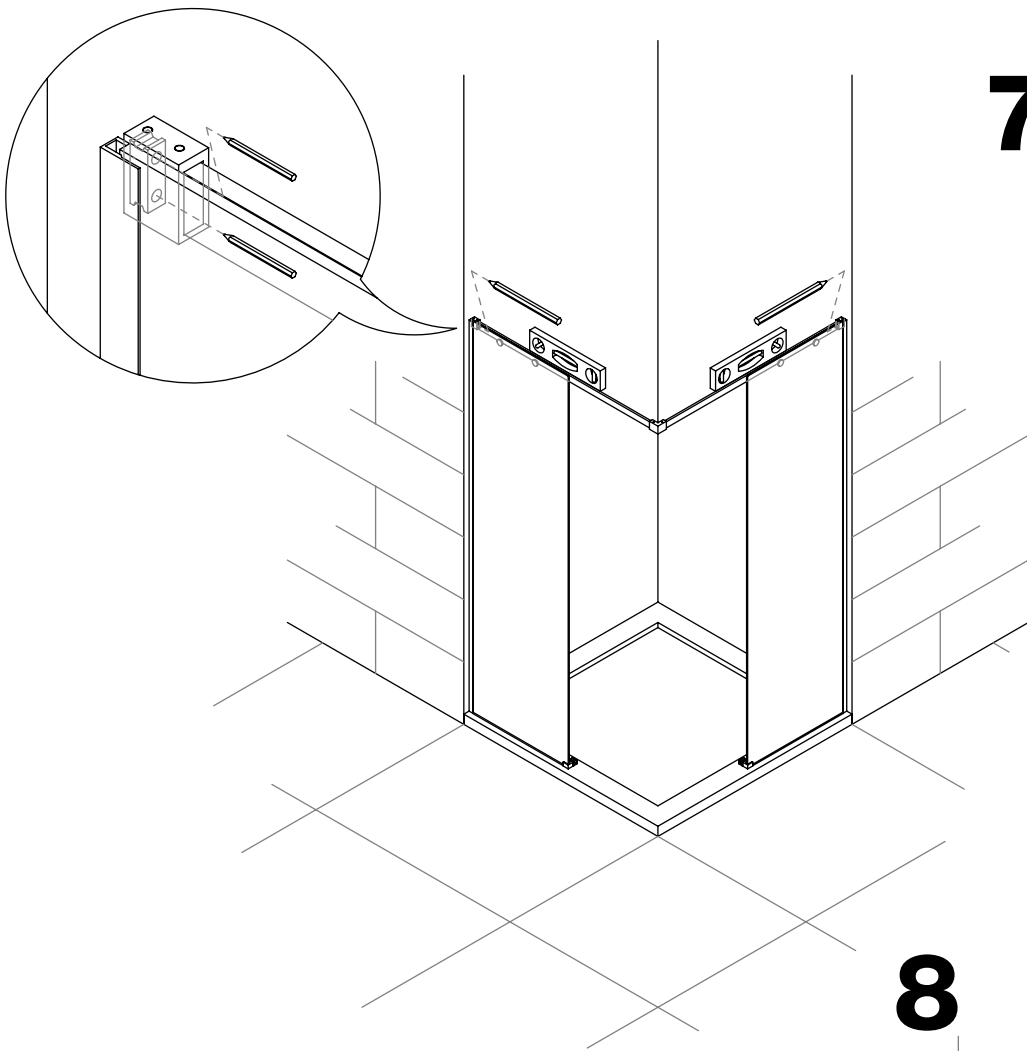

8

Percer avec foret de 6mm

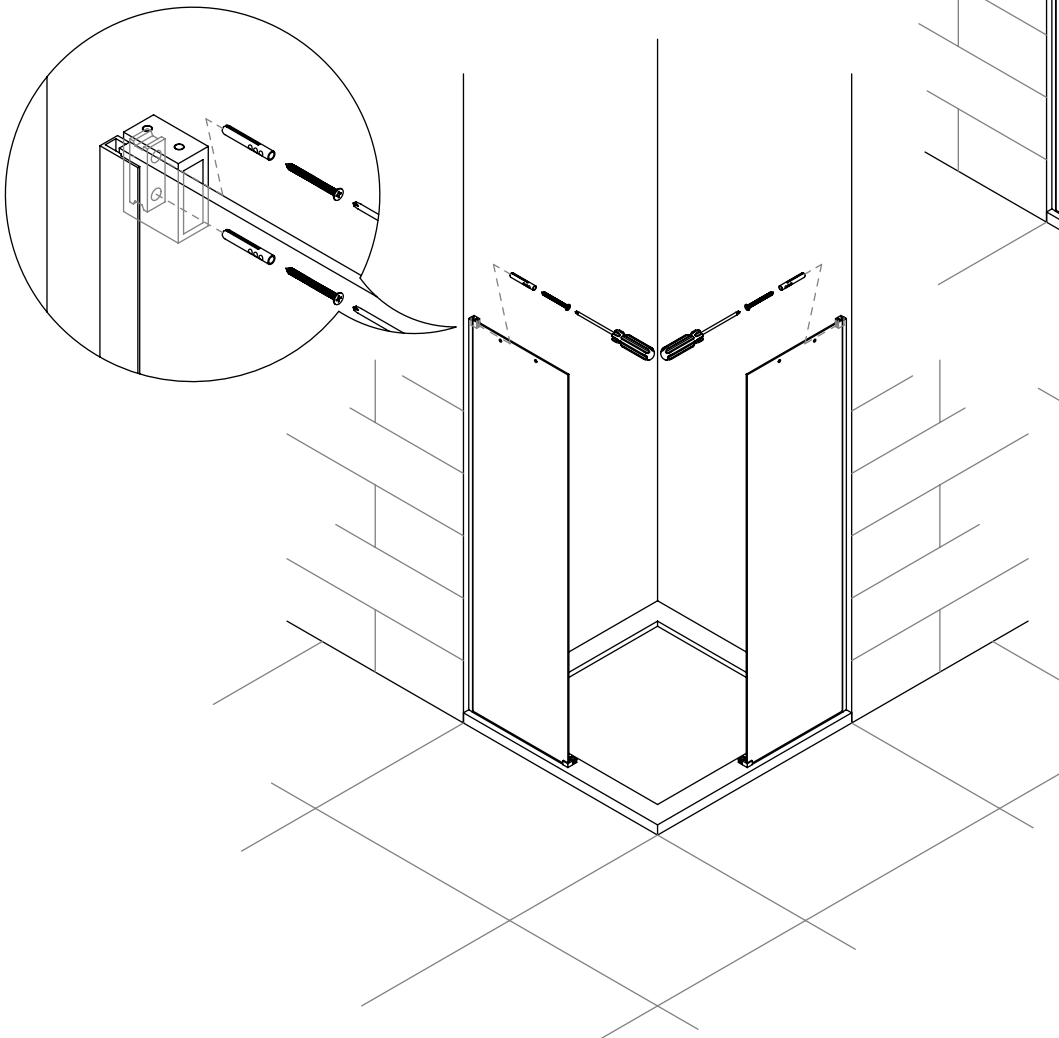
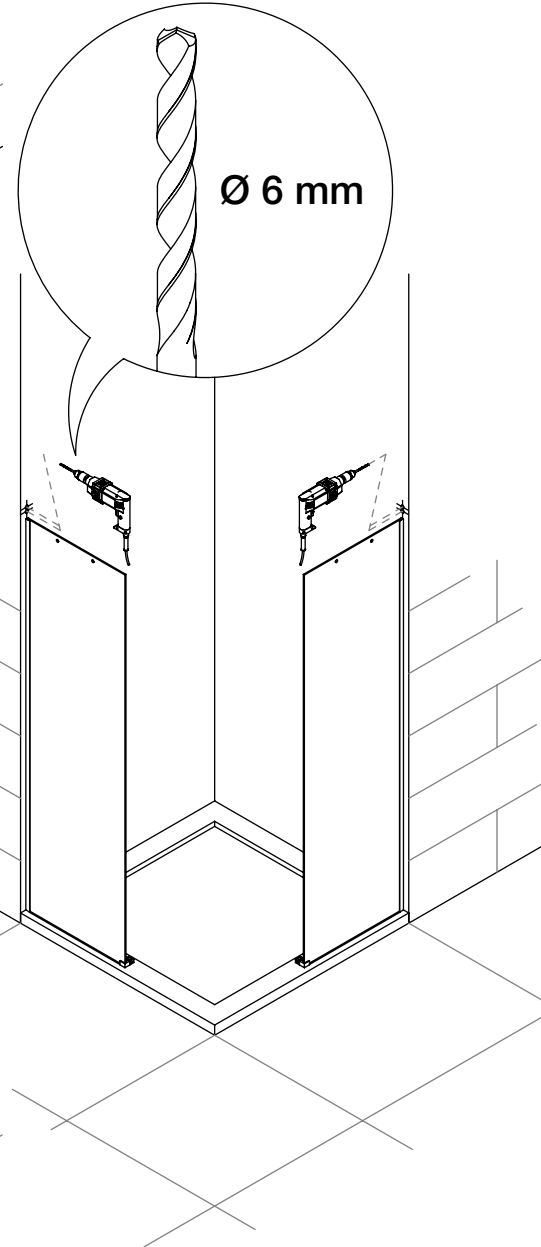

9 Visser le profilé supérieur

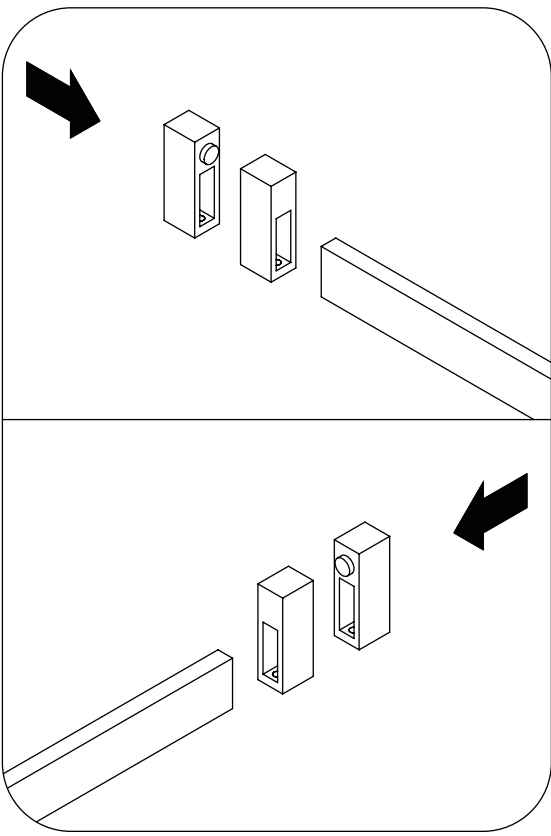

10 Introduire la buté dans le profilé.

11 Monter le verre fixe et le profilé sur les supports muraux

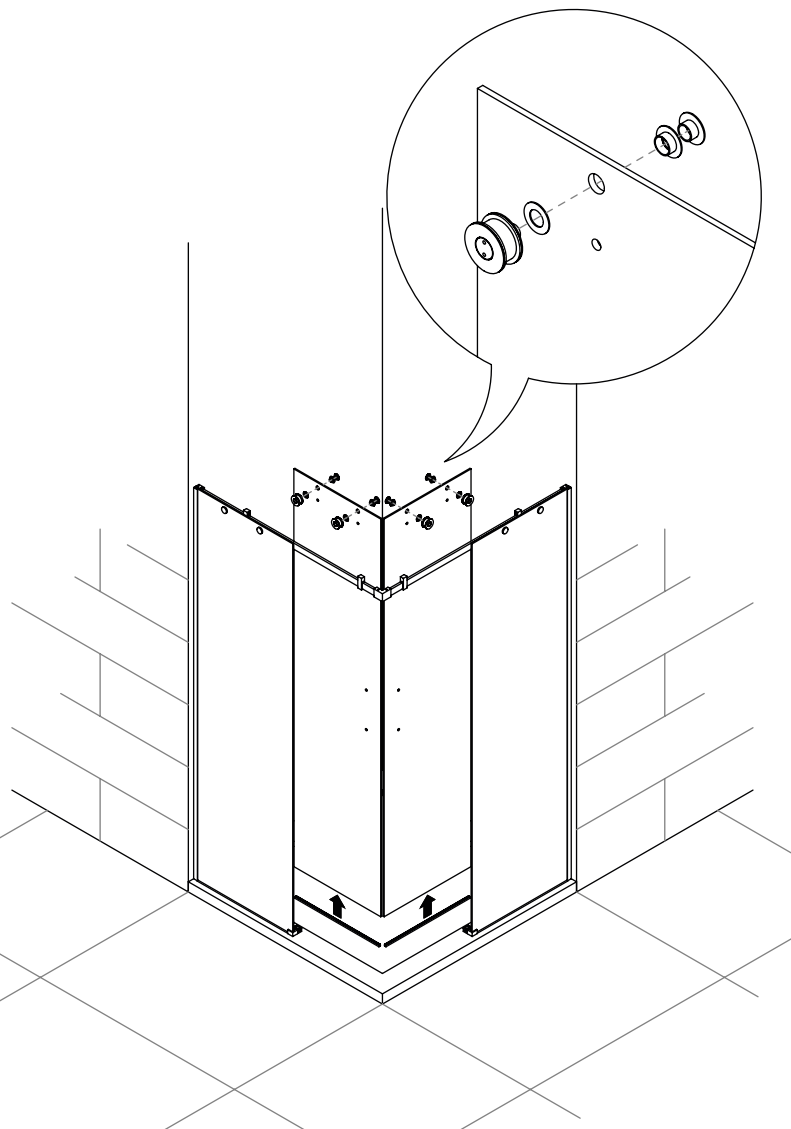
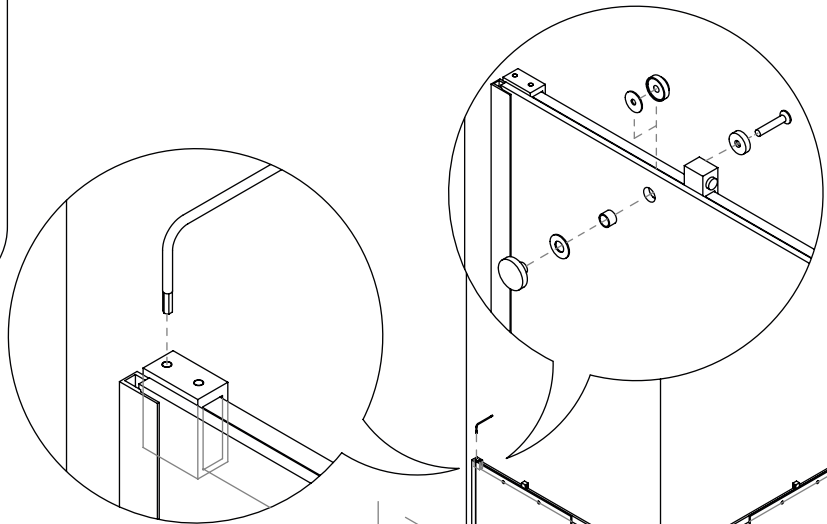

12 Régler l'aplomb du verre avec les roulements excentriques

13

Monter les joints verticaux
et le joint bulle sur le verre
coulissant coté fermeture

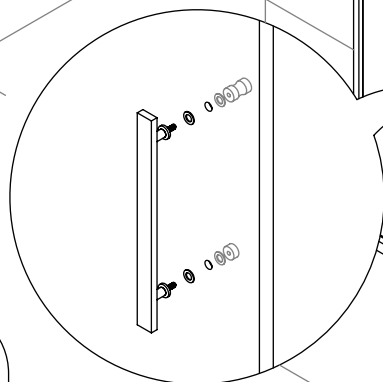
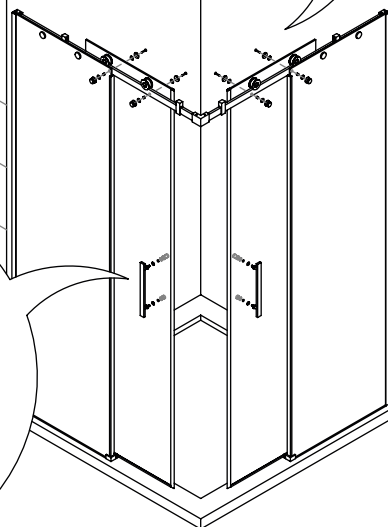
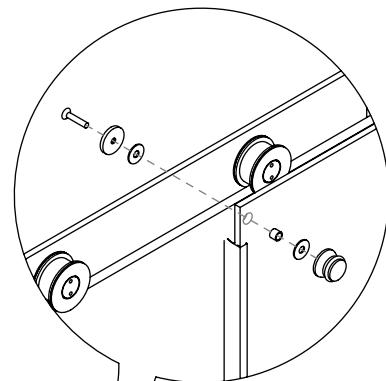
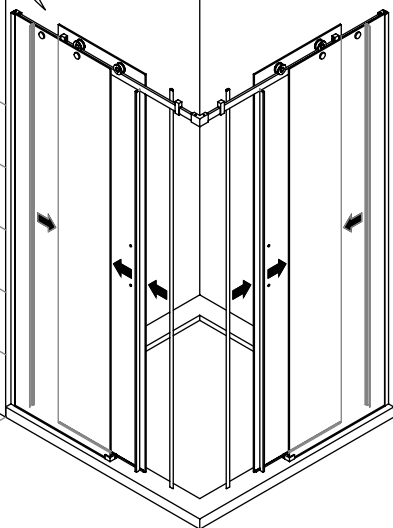
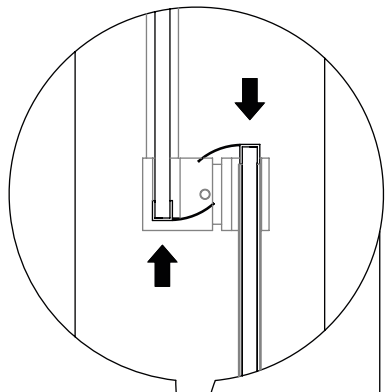

14

Ajuster les boulons
anti-bascule et monter
la poignée

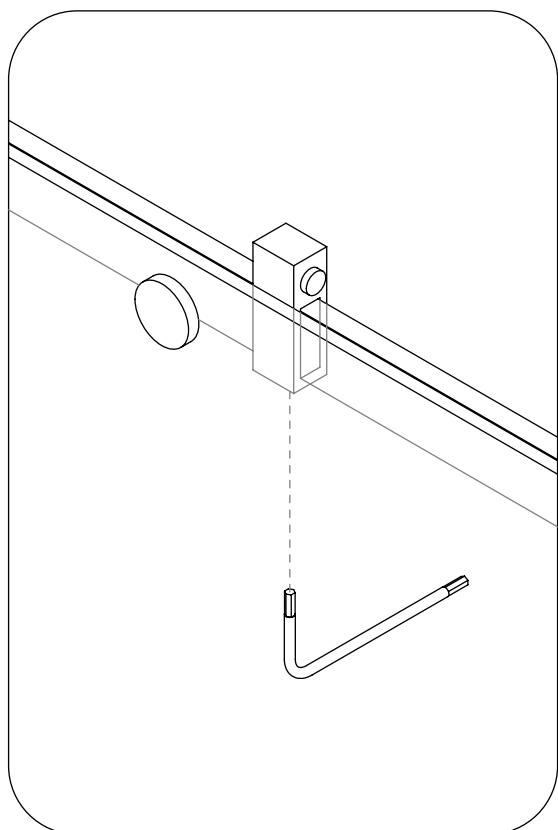

15

fixer la butée.

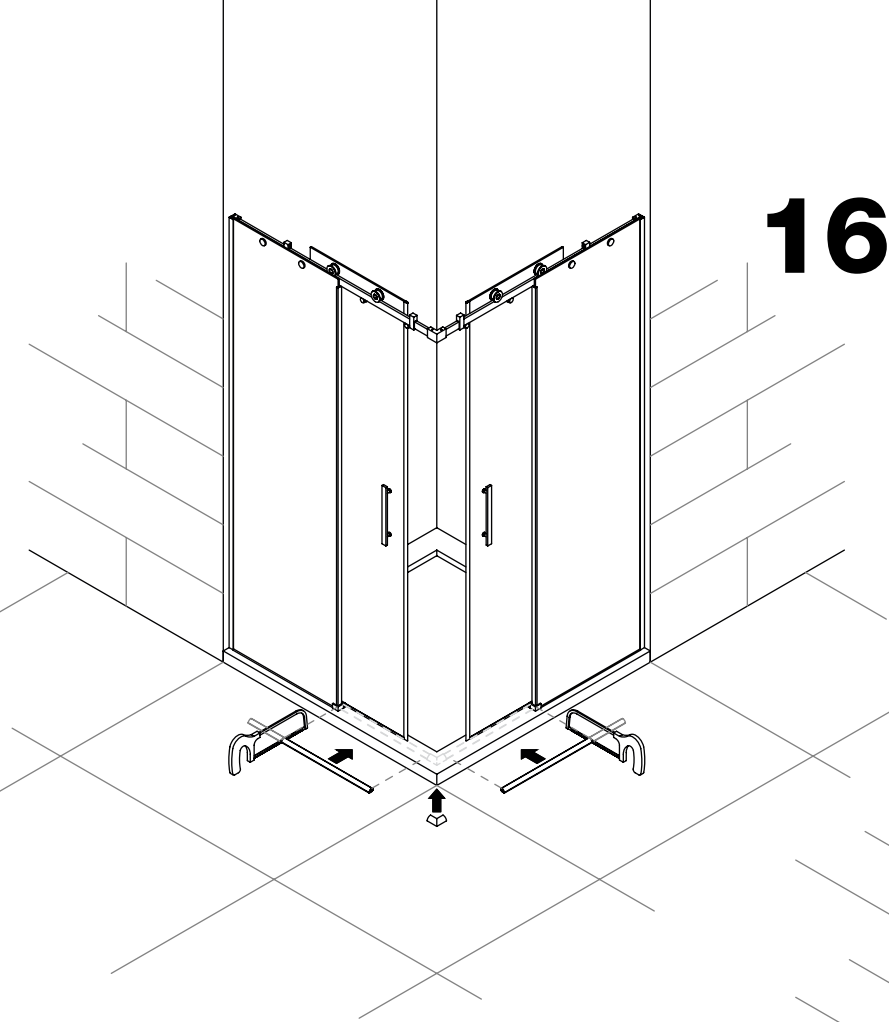

16

Couper et installer le profilé
bas d'étanchéité a la
mesure

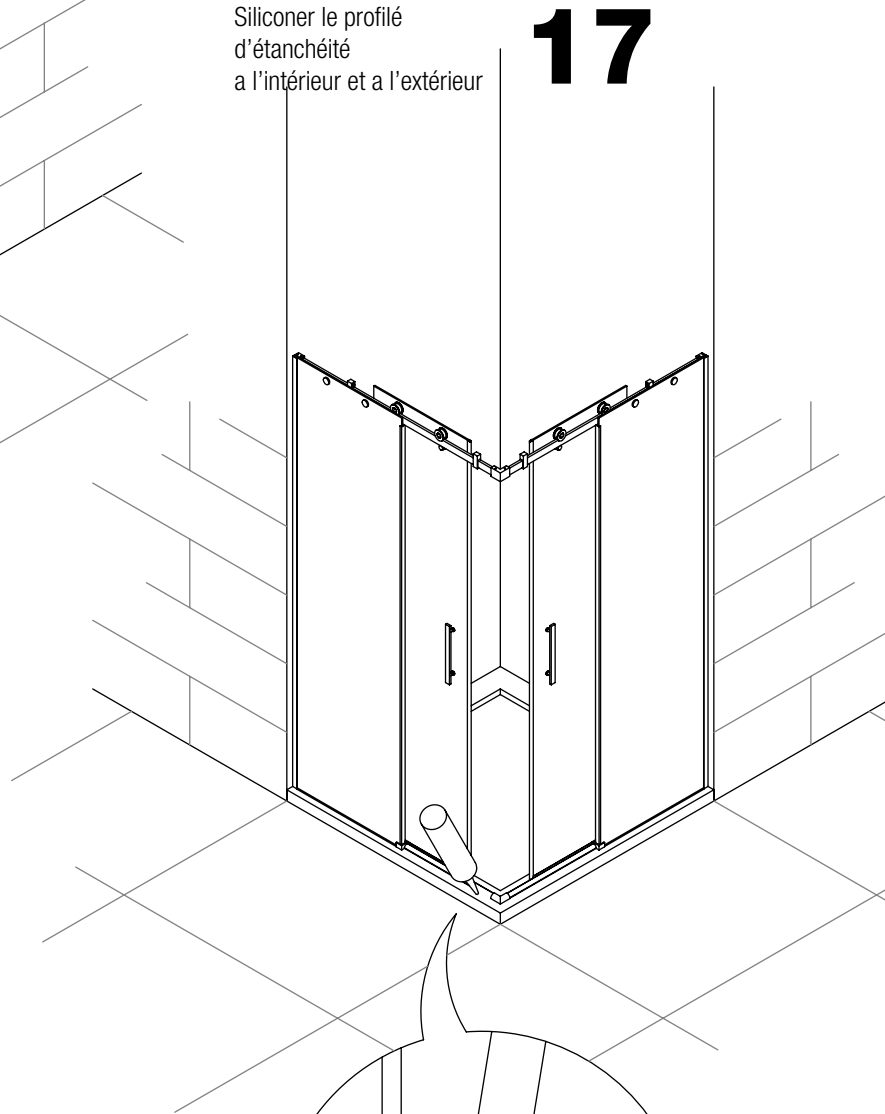

17

Siliconer le profilé
d'étanchéité
a l'intérieur et a l'extérieur

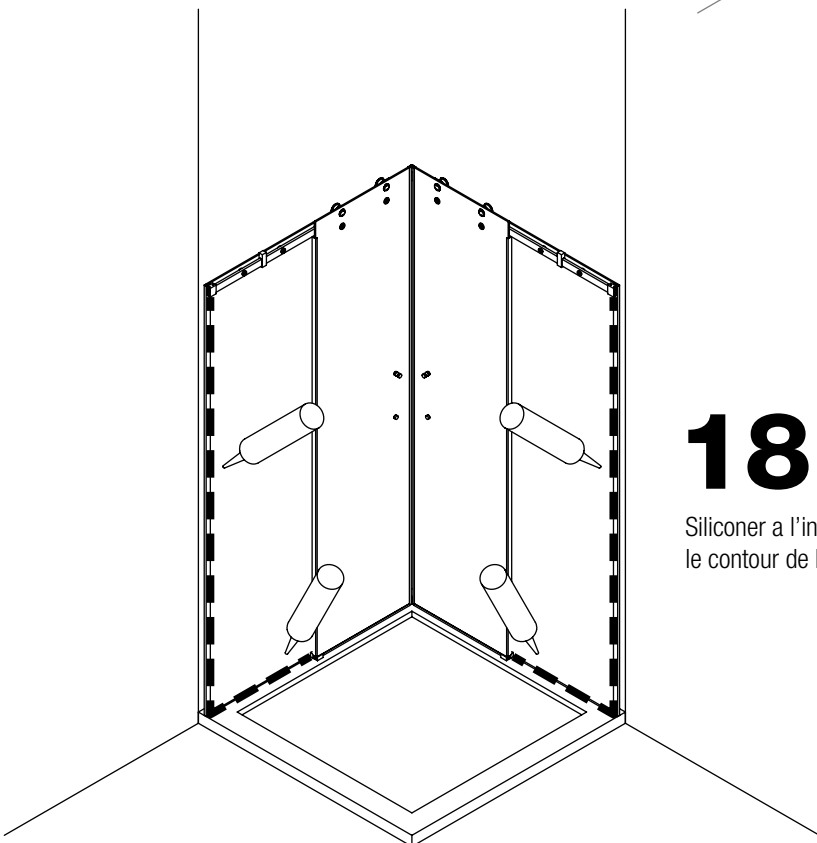

18

Siliconer a l'intérieur
le contour de la paroi.

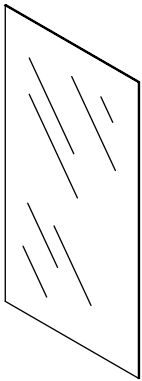
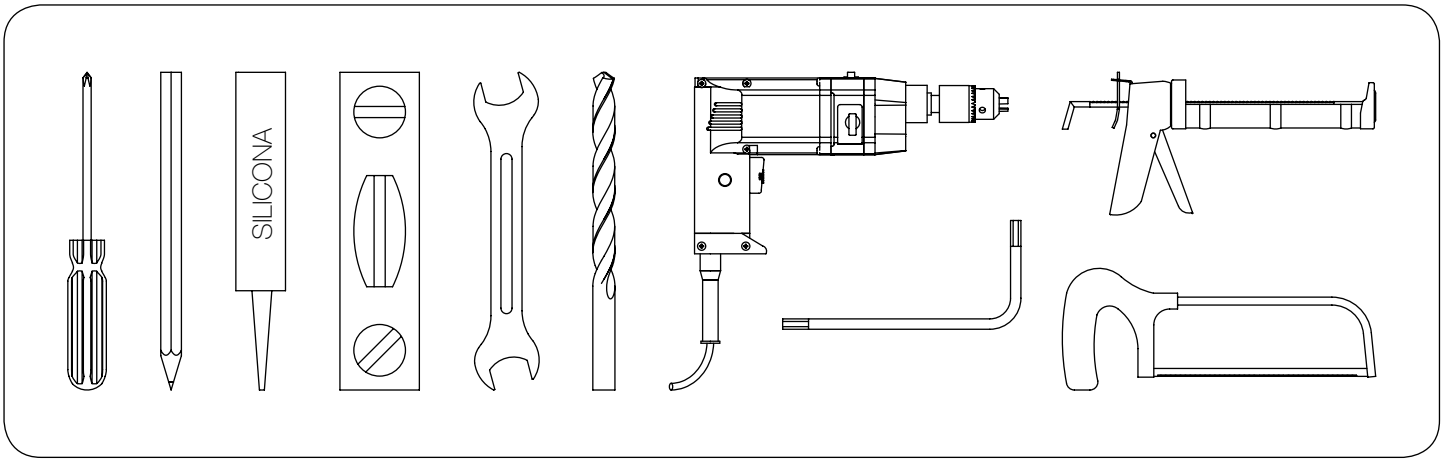

2x
verre fixe

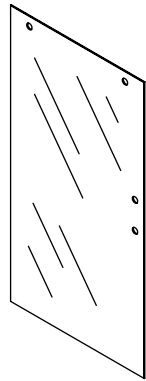

2x
verre coulissant

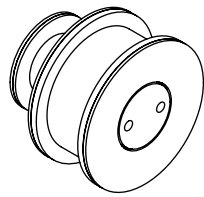

4x
roulements acier inoxydable

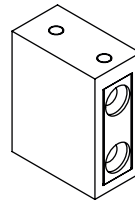

2x
support mural

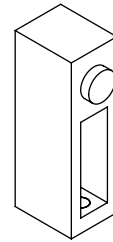

4x
buté intérieur profilé

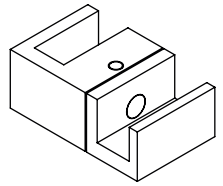

2x
guide inférieur

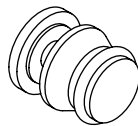

4x
boulon anti-bascule

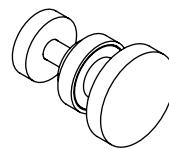

4x
fixation fixe/profilé

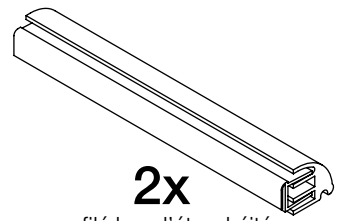

2x
profilé bas d'étanchéité

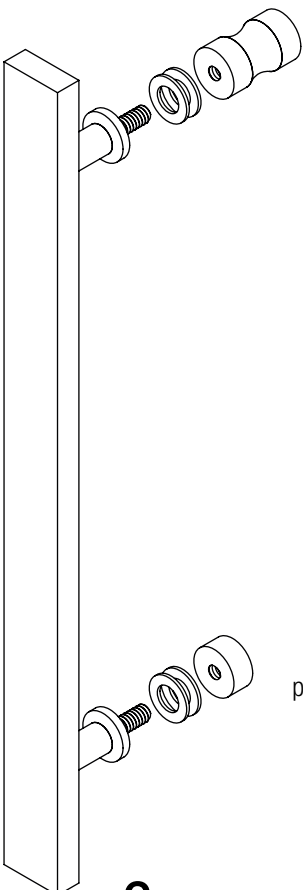

2x
poignée

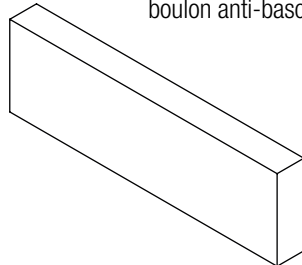

2x
profilé supérieur

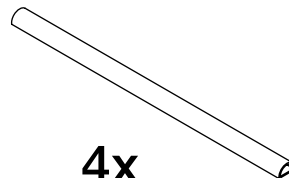

4x
bandes inférieures des fixes

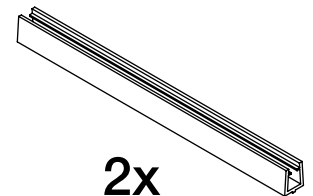

2x
joint bas de verre coulissant

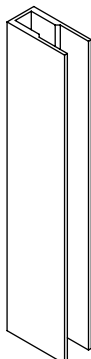

2x
profilé du fixe

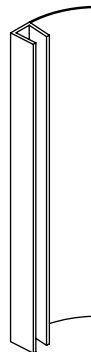

4x
joint vertical
fixe/coulissant



2x
joint verre fixe

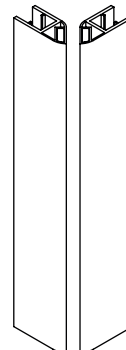

1x
fermeture aimant

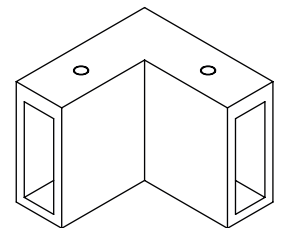

1x
coude union profilé haut

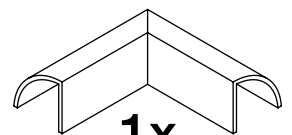

1x
coude union profilé bas
d'étanchéité



10x
chevilles n°6

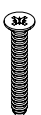

10x
vis 4,2 x 32

instructions effectuées par:



www.ar3d.es